



PARTING & GROOVING

Parting & Grooving Holders

Parting & Grooving Inserts Overview

Parting & Grooving Inserts (TD.)

Parting & Grooving - Holder - External
External holders for TD. insert

Parting & Grooving - Holder - External
External holders for TD. insert

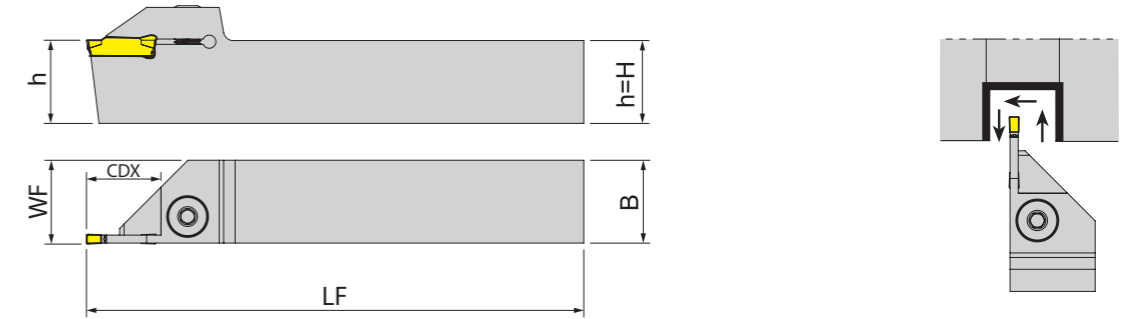
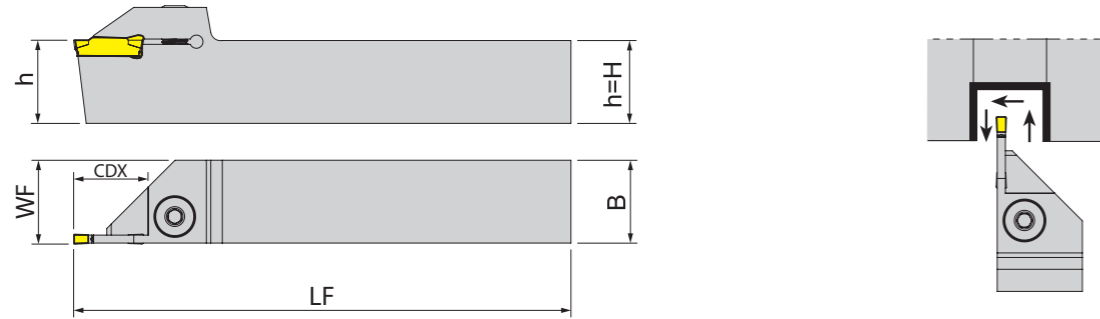

: p.103 Unit :mm

: p.103 Unit :mm

Designation	EDP 5700.. R L	CW	CDX	H	B	LF	WF	Insert
YTER/L 1212-2T15	0025 0024	2	15	12	12	100	12.3	TD2..
YTER/L 1616-2T15	0027 0026	2	15	16	16	125	16.3	
YTER/L 2020-2T15	0030 0029	2	15	20	20	125	20.3	
YTER/L 2020-2T20	0032 0031	2	20	20	20	125	20.3	
YTER/L 2020-2T9	0028 -	2	9	20	20	125	20.3	
YTER/L 2525-2T17	0034 0033	2	17	25	25	150	25.3	
YTER/L 1212-3T15	0036 0035	3	15	12	12	100	12.4	TD3..
YTER/L 1616-3T15	0038 0037	3	15	16	16	125	16.4	
YTER/L 2020-3T20	0040 0039	3	20	20	20	125	20.4	
YTER/L 2525-3T20	0044 0043	3	20	25	25	150	25.4	
YTER/L 2525-3T9	0042 0041	3	9	25	25	150	25.4	
YTER/L 3232-3T20	0045 -	3	20	32	32	170	32.4	
YTER/L 2525-4T20	0047 0046	4	20	25	25	150	25.5	TD4..
YTER/L 1212-2T15-C	● 0194 0171	2	15	12	12	100	12.3	TD2..
YTER/L 1616-2T15-C	● 0197 0174	2	15	16	16	125	16.3	
YTER/L 2020-2T15-C	● 0201 0178	2	15	20	20	125	20.3	
YTER/L 2020-2T17-C	● 0202	2	17	20	20	125	20.3	
YTER/L 2020-2T20-C	● 0203 0179	2	20	20	20	125	20.3	
YTER/L 2020-2T09-C	● 0204 0180	2	09	20	20	125	20.3	
YTER/L 2525-2T17-C	● 0208 0184	2	17	25	25	150	25.3	

Designation	EDP 5700.. R L	CW	CDX	H	B	LF	WF	Insert
YTER/L 1212-3T15-C	● 0196 0173	3	15	12	12	100	12.4	TD3..
YTER/L 1616-3T15-C	● 0199 0176	3	15	16	16	125	16.4	
YTER/L 2020-3T20-C	● 0205 0181	3	20	20	20	125	20.4	
YTER/L 2020-3T25-C	● 0206 0182	3	25	20	20	125	20.4	
YTER/L 2020-3T30-C	● 0207 0183	3	30	20	20	125	20.4	
YTER/L 2525-3T22-C	● 0209 0185	3	22	25	25	150	25.4	
YTER/L 2525-3T25-C	● 0210 0186	3	25	25	25	150	25.4	
YTER/L 2525-3T30-C	● 0211 0187	3	30	25	25	150	25.4	
YTER/L 2525-3T09-C	● 0212 0188	3	09	25	25	150	25.4	
YTER/L 3232-3T25-C	● 0217 0192	3	25	32	32	170	32.4	
YTER/L 2525-4T22-C	● 0213 0189	4	22	25	25	150	25.5	
YTER/L 2525-4T25-C	● 0214	4	25	25	25	150	25.5	
YTER/L 2525-4T30-C	● 0215 0190	4	30	25	25	150	25.5	TD4..
YTER/L 2525-5T25-C	● 0216 0191	5	25	25	25	150	25.5	TD5..

▶ NEXT PAGE

Series	Size	Screw	Ring	Wrench
YTER/L	..2..	YAKV-02-M6x22	YABPL-01	YAAL-03-3
	..3../..4../..5..	Y2004-M8x1x20	-	YAAL-05-4

Series	Size	Screw	Ring	Wrench
YTER/L	..2..	YAKV-02-M6x22	YABPL-01	YAAL-03-3
	..3../..4../..5..	Y2004-M8x1x20	-	YAAL-05-4

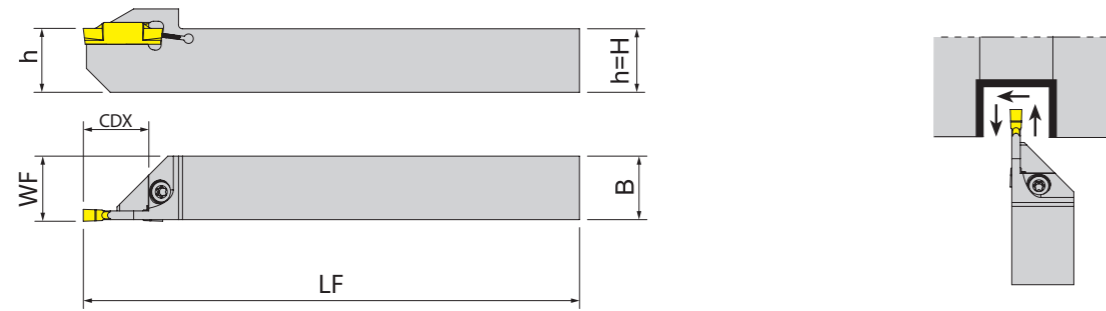
External holders (Swiss Lathe) for TD. insert

: p. 103 Unit :mm

Designation	EDP 5700.. R	L	CW	CDX	H	B	LF	WF	Insert
YTER/L 1212-2T12-S	0048	-	2	12	12	12	125	12.2	TD.2..
YTER/L 1616-2T16-S	0049	-	2	16	16	16	125	16.2	
YTER/L 1212-3T12-S	0051	0050	3	12	12	12	125	12.3	TD.3..
YTER/L 1616-3T16-S	0053	0052	3	16	16	16	125	16.3	
YTER/L 1212-2T12-S-C	● 0193	0170	2	12	12	12	125	12.2	TD.2..
YTER/L 1616-2T16-S-C	● 0198	0175	2	16	16	16	125	16.2	
YTER/L 1212-3T12-S-C	● 0195	0172	3	12	12	12	125	12.3	TD.3..
YTER/L 1616-3T16-S-C	● 0200	0177	3	16	16	16	125	16.3	

: p. 103 Unit :mm

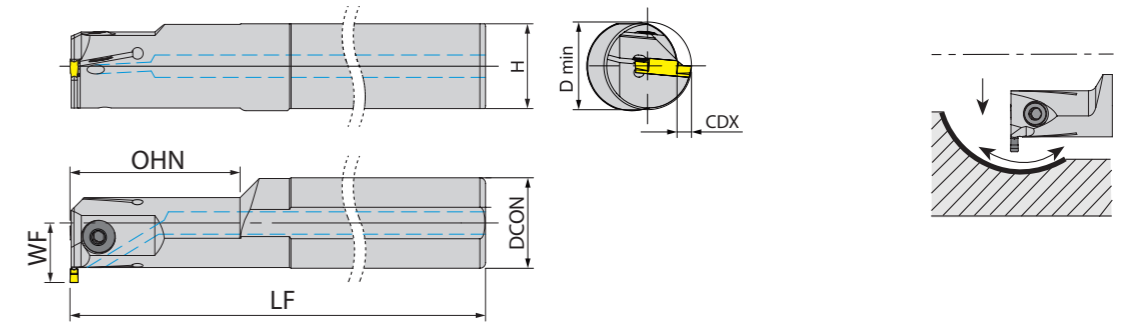
Internal holders for TD. insert

: p. 103 Unit :mm

Designation	EDP 5700.. R	L	CW	DMIN	CDX	DCON	H	OHN	LF	WF	Insert
YTIR/L 16-2T8.5-C	● 0222	0218	2	25	8.5	16	14.8	28	150	16.5	TD.2..
YTIR/L 20-3T06-C	● 0223	0219	3	25	6	20	18.3	40	170	16	
YTIR/L 25-3T06-C	● 0224	0220	3	25	6	25	23	40	200	18.5	TD.3..
YTIR/L 32-3T05-C	● 0225	0221	3	31	5	32	30	60	250	21	

Series	Size	Screw	Wrench
YTER/L	..S	Y4015-M4x11	Y80-T15

Series	Size	Screw	Wrench
YTIR/L	16-2T..	Y2503-M4x10	YAAL-03-3
	20~25-3T..	Y2504-M5x12	YAAL-05-4
	32-3T..	Y2004-M8x1x20	YAAL-05-4

Parting & Grooving - Holder
Blade for TD. insert

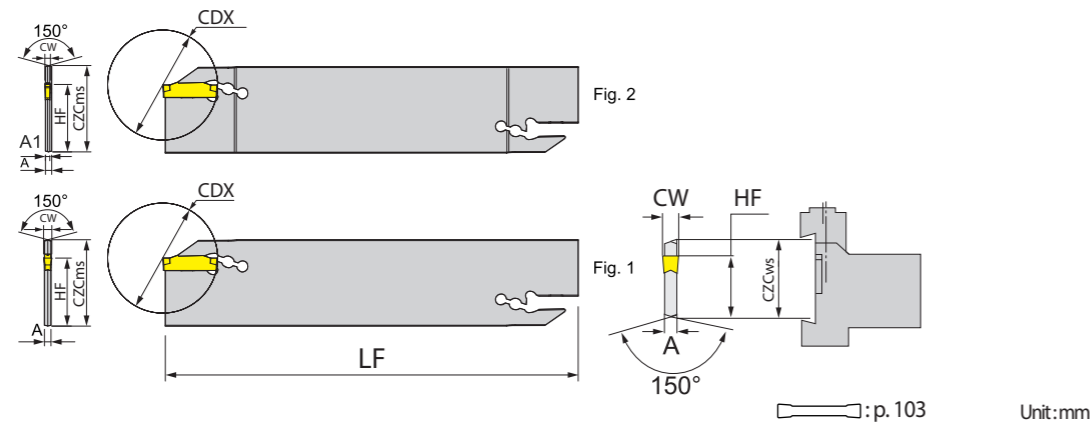

Designation	EDP 5700..	CZCms	CW	CDX	HF	LF	W	Insert
YGB 32-2	0058	32	2	20	25	150	2.4	TD.2..
YGB 32-3	0059	32	3	20	25	150	2.4	TD.3..
YGB 32-2-C	● 0226	32	2	20	25	150	2.4	TD.2..
YGB 32-3-C	● 0227	32	3	20	25	150	2.4	TD.3..

Series	Wrench
YGB ..	YALA-01

Parting & Grooving - Holder
Blade Block for TD. insert

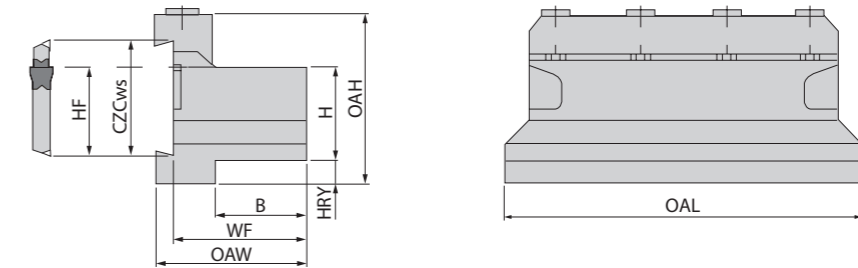

Designation	EDP 5700..	CZCms	H	B	HF	WF	HRY	OAL	OAH	OAW
YGBU 20-32	0060	32	20	19	25	32.7	13	100	50	38
YGBU 25-32	0061	32	25	23	25	36.7	8	110	50	42
YGBU 32-32	0062	32	32	29	25	42.7	5	110	54	48
YGBU 20-32-C	● 0228	32	20	19	25	32.7	13	100	50	38
YGBU 25-32-C	● 0229	32	25	23	25	36.7	8	110	50	42
YGBU 32-32-C	● 0230	32	32	29	25	42.7	5	110	54	48

Series	Size	Clamp	Screw	Wrench
YGBU	20-32	YABK-03	Y2505-M6x30	YAAL-07-5
	25~32-32	YABK-04	Y2505-M6x30	YAAL-07-5

Parting & Grooving Overview

Parting & Groove Turn Grades

Parting and Grooving Grades	P Steel				M Stainless steel				K Cast iron			N Non Ferrous		S Super Alloy	
	P10	P20	P30	P40	M10	M20	M30	M40	K10	K20	K30	N10	N20	S10	S20
PVD	YG602G (YG602)	602G				602G				602G					602G
	YG603					603									

YG602G (YG602)

P20 - P35 M20 - M40
K20 - K40 S15 - S25

PVD - TiAlN

Universal grade for Parting & Groove Turn

- Ultra Dense PVD Coating with optimal thermal resistance & strength
- Sub-Micron substrate designed for demanding application
- YG602G : First Choice for Low Cutting Speed, Soft and Sticky Material with Low Hardness
- YG602 : First Choice for General Application

YG603

M30 - M50

PVD - TiAlN

PVD Parting & Grooving Grade for Stainless Steel

- Ultra high toughness substrate and strong adhesion
- Excellent cutting edge strength and chipping resistance
- Stable machinability and tool life for stainless steel

Parting & Grooving Inserts

Inserts	TD. Series	2, 3, 4, 6

Parting & Grooving Chipbreakers

-P TDP			• Parting & Grooving (Positive)
-N TDN			• Parting & Grooving (General)
-Y TDY			• Turning, Parting & Grooving

Parting & Grooving - Inserts

Parting & Grooving Inserts

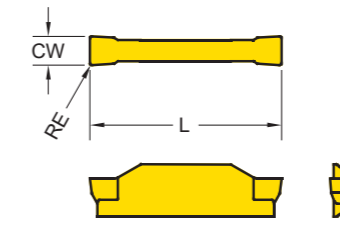

Series	L	CW
TD* 2	20	2
TD* 3	20	3
TD* 4	20	4
TD* 5	20	5

* CDX : Cutting Depth Maximum

EDP 5200.
● : Stock item ○ : Order made item

TD.	Designation	RE	Parting & Grooving		Turning		YG602	YG602G	YG603
			Fn (mm/rev.)	CDX (mm)	Fn (mm/rev.)	Ap (mm)			
-P 	TDP2002	0.2	0.04 ~ 0.12	19	-	-	●	●	●
	TDP3002	0.2	0.05 ~ 0.16	19	-	-	●	●	●
	TDP4003	0.3	0.06 ~ 0.18	19	-	-	●	●	●
	TDPR2002-6	0.2	0.04 ~ 0.12	19	-	-	●	●	●
	TDPR3002-6	0.3	0.05 ~ 0.15	19	-	-	●	●	●
	TDPL2002-6	0.2	0.04 ~ 0.12	19	-	-	●	●	●
-N 	TDPL3002-6	0.3	0.05 ~ 0.15	19	-	-	●	●	●
	TDN2002	0.2	0.04 ~ 0.12	19	-	-	●	●	●
	TDN3002	0.2	0.07 ~ 0.22	19	-	-	●	●	●
	TDN4003	0.3	0.08 ~ 0.25	19	-	-	●	●	●
	TDN5003	0.3	0.09 ~ 0.35	25	-	-	●	●	●
	TDNR2002-6	0.2	0.04 ~ 0.12	19	-	-	●	●	●
-Y 	TDNR3002-6	0.3	0.07 ~ 0.20	19	-	-	●	●	●
	TDNL2002-6	0.2	0.04 ~ 0.12	19	-	-	●	●	●
	TDNL3002-6	0.3	0.07 ~ 0.20	19	-	-	●	●	●
	TDY3E-0.4	0.4	0.10 ~ 0.20	19	0.10 ~ 0.38	0.50 ~ 2.20		●	
	TDY4E-0.4	0.4	0.15 ~ 0.26	19	0.10 ~ 0.40	0.50 ~ 2.80		●	
								●	

ISO	VDI	Sub Group	Cutting Speed Vc (m/min.)			
			YG602G (YG602)		YG603	
			Min.	Max.	Min.	Max.
P	1-5	Non-Alloyed Steel	120	180		
	6-9	Low-Alloyed Steel	100	140		
	10-11	High-Alloyed Steel	80	110		
M	12-13	Ferritic & Martensitic	70	160	50	90
	14	Austenitic Stainless Steel	55	140	40	80
K	15-16	Grey Cast Iron	110	185		
	17-18	Nodular Cast Iron	110	140		
N	21-30	Non-Ferrous Metals (Al)	250	440		
S	31-37	Superalloys & Titanium	25	45		
H	38-41	Hard Materials	25	50		