

YG-1 TOOLING SYSTEM

SHRINK FIT HOLDER

- SCHRUMPFUTTER
- MANDRIN DE FRETTAGE
- MADRINI PER CALLETAMENTO A CALDO
- PORTAHERRAMIENTAS DE COMPRESION POR CALOR



DIN 69871-SK

DIN 69893/ISO 12164-1-HSK

CBT (BT DUAL CONTACT)

JIS B6339/MAS 403-BT

ISO 25

STRAIGHT (EXTENSION)

SHRINK FIT HEATING MACHINE

SHRINK FIT HOLDER

High Precision I.D Run-out : $\leq 0.003\text{mm}$

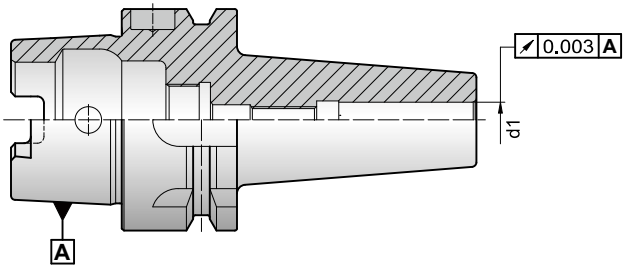

- Less than 0.003mm of Tool Holder accuracy at I.D

Strong and Consistent Torque Power

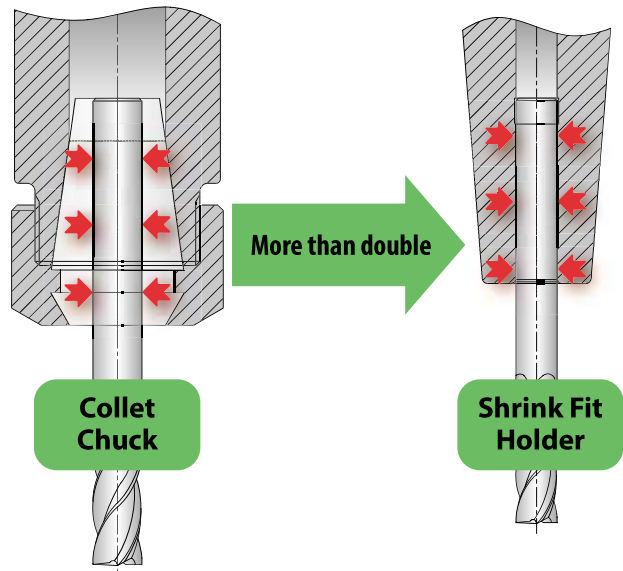

- Achieving strong torque power by integration of chuck and tool

Deep hole Machining

Collet Chuck

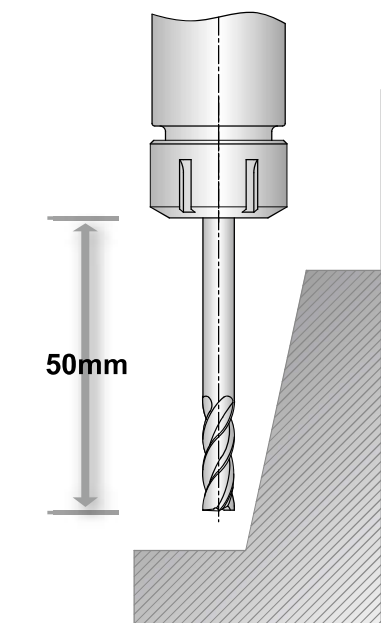

Shrink Fit Holder

More favorable in deep hole machining

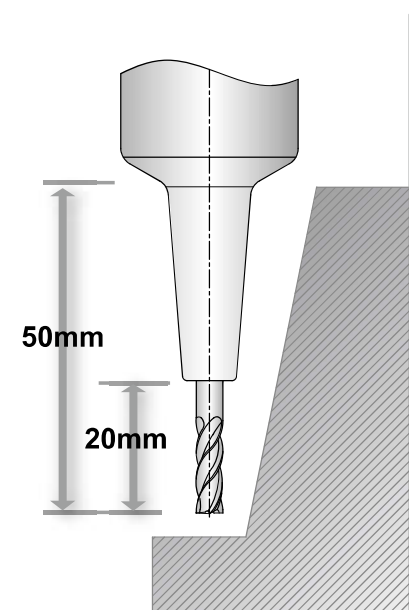

- Suitable for High-Speed precision deep hole machining

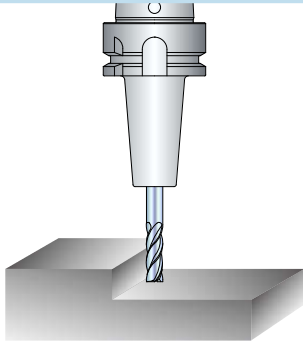
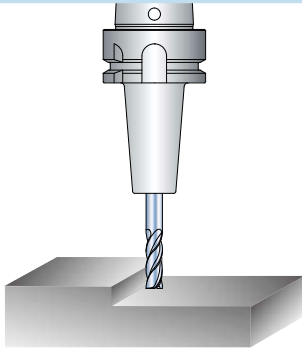
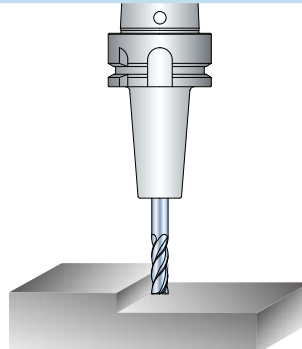
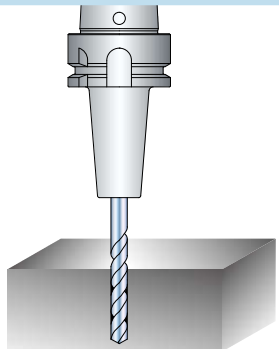
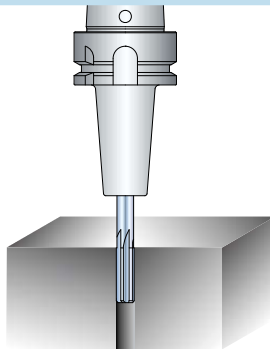
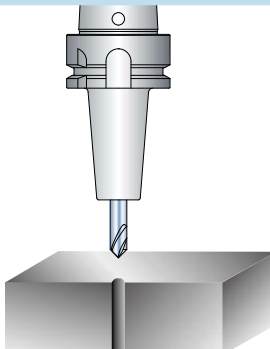
APPLICATION		
Rough Milling 	Finish Milling 	High-Speed Cutting 
Drilling 	Reaming 	Countersinking 

Shank Type of Cutting Tool

Straight shank



One weldon flat shaft type



• One Weldon flat shaft type tool is usable, but there is a possibility that the I.D of shrink fit holder may be deformed.

Material of Cutting Tool

CARBIDE
TOOL

HSS
TOOL

OK

NO



SHRINK FIT HOLDER (EXTRA SLIM)

DIN 69871-SK

SCHRUMPFUTTER
MANDRIN DE FRETAGE
MADRINI PER CALLETAMENTO A CALDO
PORTAHERRAMIENTAS DE COMPRESION POR CALOR

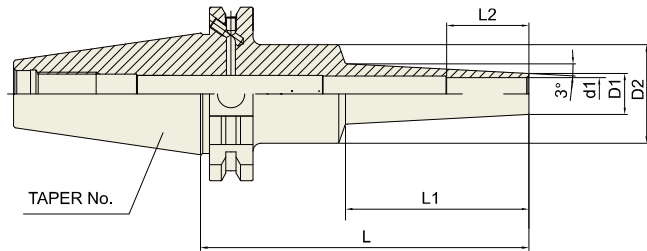

Unit : mm

TAPER No.	MODEL No.	EDP No.	d1	D1	D2	L	L1	L2	WEIGHT (kg)
30	SK30-SFHS3-60	P2771332S	3	6	20	60	22	9	-
	SK30-SFHS3-80	P2771333S	3	6	20	80	42	9	-
	SK30-SFHS4-60	P2771334S	4	7	20	60	22	12	-
	SK30-SFHS4-80	P2771335S	4	7	20	80	42	12	-
	SK30-SFHS6-60	P2771336S	6	9	20	60	22	18	-
	SK30-SFHS6-80	P2771337S	6	9	20	80	42	18	-
40	SK40AD/B-SFHS3-95	P2771338S	3	6	26	95	42	9	0.89
	SK40AD/B-SFHS3-120	P2771339S	3	6	26	120	67	9	0.91
	SK40AD/B-SFHS4-95	P2771340S	4	7	26	95	42	12	0.90
	SK40AD/B-SFHS4-120	P2771341S	4	7	26	120	67	12	0.92
	SK40AD/B-SFHS6-95	P2771342S	6	9	26	95	42	18	0.90
	SK40AD/B-SFHS6-120	P2771343S	6	9	26	120	67	18	0.93
	SK40AD/B-SFHS8-95	P2771344S	8	11	36	95	42	24	0.90
	SK40AD/B-SFHS8-120	P2771345S	8	11	36	120	67	24	1.01
	SK40AD/B-SFHS10-95	P2771346S	10	13	36	95	42	30	0.91
	SK40AD/B-SFHS10-120	P2771347S	10	13	36	120	67	30	1.02
	SK40AD/B-SFHS12-95	P2771348S	12	15	36	95	42	30	0.99
	SK40AD/B-SFHS12-120	P2771349S	12	15	36	120	67	30	1.02
50	SK50AD/B-SFHS3-110	P2771350S	3	6	26	110	42	9	2.77
	SK50AD/B-SFHS3-160	P2771351S	3	6	26	160	97	9	2.79
	SK50AD/B-SFHS4-110	P2771352S	4	7	26	110	42	12	2.75
	SK50AD/B-SFHS4-160	P2771353S	4	7	26	160	97	12	2.80
	SK50AD/B-SFHS6-110	P2771354S	6	9	26	110	42	18	2.74
	SK50AD/B-SFHS6-160	P2771355S	6	9	26	160	97	18	2.85
	SK50AD/B-SFHS8-110	P2771356S	8	11	36	110	42	24	2.84
	SK50AD/B-SFHS8-160	P2771357S	8	11	36	160	97	24	2.92
	SK50AD/B-SFHS10-110	P2771358S	10	13	36	110	42	30	2.85
	SK50AD/B-SFHS10-160	P2771359S	10	13	36	160	97	30	2.93
	SK50AD/B-SFHS12-110	P2771360S	12	15	36	110	42	30	2.85
	SK50AD/B-SFHS12-160	P2771361S	12	15	36	160	97	30	2.96

► CAT(ANSI B5.50) taper and Inch type products are available.



SHRINK FIT HOLDER

SFH

SHRINK FIT HOLDER

DIN 69871-SK

SCHRUMPFUTTER
MANDRIN DE FRETTAGE
MADRINI PER CALLETAMENTO A CALDO
PORTAHERRAMIENTAS DE COMPRESION POR CALOR



FIG.1

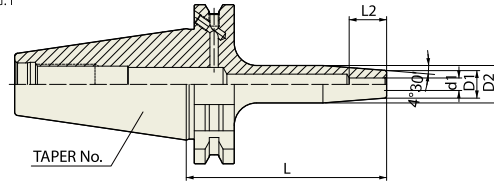
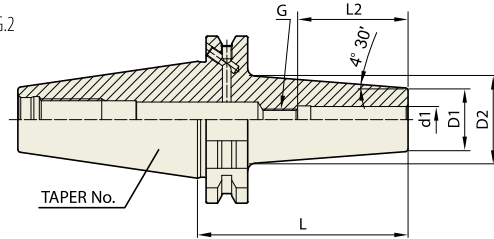

FIG.2



Unit : mm

TAPER No.	MODEL No.	EDP No.	d1	D1	D2	L	L2	G	FIG.	WEIGHT (kg)
30	SK30AD/B-SFH3-60	P2771308	3	11	15	60	10	-	1	0.40
	SK30AD/B-SFH4-60	P2771309	4	11	15	60	12	-	1	0.40
	SK30AD/B-SFH5-60	P2771310	5	11	15	60	15	-	1	0.40
	SK30AD/B-SFH6-60	P2771311	6	21	27	60	36	M5×0.8	2	0.40
	SK30AD/B-SFH8-60	P2771312	8	21	27	60	36	M6×1.0	2	0.40
	SK30AD/B-SFH10-80	P2771313	10	24	32	80	42	M8×1.0	2	0.40
	SK30AD/B-SFH12-80	P2771314	12	24	32	80	47	M10×1.0	2	0.42
	SK30AD/B-SFH14-80	P2771315	14	27	34	80	47	M10×1.0	2	-
	SK30AD/B-SFH16-80	P2771316	16	27	34	80	50	M12×1.0	2	0.42
	SK30AD/B-SFH18-80	P2771317	18	33	42	80	50	M12×1.0	2	-
SK30AD/B-SFH20-90	P2771318	20	33	42	90	52	M16×1.0	2	0.44	
40	SK40AD/B-SFH3-80	P2771301	3	11	15	80	10	-	1	1.00
	SK40AD/B-SFH4-80	P2771302	4	11	15	80	12	-	1	1.00
	SK40AD/B-SFH5-80	P2771303	5	11	15	80	15	-	1	1.00
	SK40AD/B-SFH6-80	P2554058	6	21	27	80	36	M5×0.8	2	1.10
	SK40AD/B-SFH6-160	P2771304	6	21	27	160	36	M5×0.8	2	1.15
	SK40AD/B-SFH8-80	P2600009	8	21	27	80	36	M6×1.0	2	1.11
	SK40AD/B-SFH8-160	P2771305	8	21	27	160	36	M6×1.0	2	1.15
	SK40AD/B-SFH10-80	P2554052	10	24	32	80	42	M8×1.0	2	1.10
	SK40AD/B-SFH10-160	P2771306	10	24	32	160	42	M8×1.0	2	1.15
	SK40AD/B-SFH12-80	P2600008	12	24	32	80	47	M10×1.0	2	1.10
	SK40AD/B-SFH12-160	P2771307	12	24	32	160	47	M10×1.0	2	1.15
	SK40AD/B-SFH14-80	P2771319	14	27	34	80	47	M10×1.0	2	1.20
	SK40AD/B-SFH14-160	P2771320	14	27	34	160	47	M10×1.0	2	1.50
	SK40AD/B-SFH16-80	P2554054	16	27	34	80	50	M12×1.0	2	1.20
	SK40AD/B-SFH16-160	P2554053	16	27	34	160	50	M12×1.0	2	1.50
	SK40AD/B-SFH18-80	P2771321	18	33	42	80	50	M12×1.0	2	1.30
	SK40AD/B-SFH18-160	P2771322	18	33	42	160	50	M12×1.0	2	1.60
	SK40AD/B-SFH20-80	P2554056	20	33	42	80	52	M16×1.0	2	1.40
	SK40AD/B-SFH20-160	P2554055	20	33	42	160	52	M16×1.0	2	1.70
	SK40AD/B-SFH25-90	P2771323	25	44	53	90	58	M16×1.0	2	1.70
SK40AD/B-SFH25-160	P2771324	25	44	53	160	58	M16×1.0	2	2.00	

▶ CAT(ANSI B5.50) taper and Inch type products are available.
▶ Without balancing screw.

▶ NEXT PAGE

SHRINK FIT HOLDER

DIN 69871-SK

SCHRUMPFUTTER
MANDRIN DE FRETAGE
MADRINI PER CALLETAMENTO A CALDO
PORTAHERRAMIENTAS DE COMPRESION POR CALOR

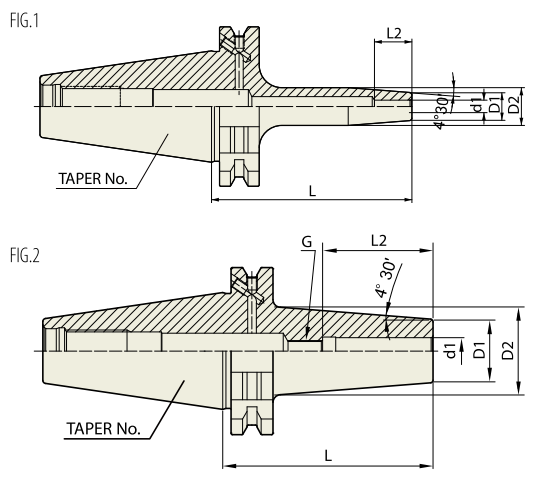

										Unit : mm
TAPER No.	MODEL No.	EDP No.	d1	D1	D2	L	L2	G	FIG.	WEIGHT (kg)
50	SK50AD/B-SFH3-80	P2771325	3	11	15	100	10	-	1	1.50
	SK50AD/B-SFH4-80	P2771326	4	11	15	100	12	-	1	1.50
	SK50AD/B-SFH5-80	P2771327	5	11	15	100	15	-	1	1.50
	SK50AD/B-SFH6-80	P2771328	6	21	27	80	36	M5×0.8	2	1.50
	SK50AD/B-SFH6-160	P2771329	6	21	27	160	36	M5×0.8	2	2.00
	SK50AD/B-SFH8-80	P2760010	8	21	27	80	36	M6×1.0	2	1.50
	SK50AD/B-SFH8-160	P2760015	8	21	27	160	36	M6×1.0	2	2.00
	SK50AD/B-SFH10-80	P2761010	10	24	32	80	42	M8×1.0	2	1.50
	SK50AD/B-SFH10-160	P2761015	10	24	32	160	42	M8×1.0	2	2.00
	SK50AD/B-SFH12-80	P2762010	12	24	32	80	47	M10×1.0	2	1.50
	SK50AD/B-SFH12-160	P2762015	12	24	32	160	47	M10×1.0	2	2.00
	SK50AD/B-SFH14-80	P2763010	14	27	34	80	47	M10×1.0	2	1.60
	SK50AD/B-SFH14-160	P2763015	14	27	34	160	47	M10×1.0	2	2.10
	SK50AD/B-SFH16-80	P2764010	16	27	34	80	50	M12×1.0	2	1.60
	SK50AD/B-SFH16-160	P2764015	16	27	34	160	50	M12×1.0	2	2.10
	SK50AD/B-SFH18-80	P2765010	18	33	42	80	50	M12×1.0	2	1.60
	SK50AD/B-SFH18-160	P2765015	18	33	42	160	50	M12×1.0	2	2.00
	SK50AD/B-SFH20-80	P2766010	20	33	42	80	52	M16×1.0	2	1.80
	SK50AD/B-SFH20-160	P2766015	20	33	42	160	52	M16×1.0	2	2.20
	SK50AD/B-SFH25-90	P2771330	25	44	53	90	58	M16×1.0	2	2.00
SK50AD/B-SFH25-160	P2771331	25	44	53	160	58	M16×1.0	2	2.40	

- ▶ CAT(ANSI B5.50) taper and Inch type products are available.
- ▶ Without balancing screw.



SHRINK FIT HOLDER

SFH

SHRINK FIT HOLDER (COOLANT CHANNEL)

DIN 69871-SK

SCHRUMPFUTTER

MANDRIN DE FRETTAGE

MADRINI PER CALLETAMENTO A CALDO

PORTAHERRAMIENTAS DE COMPRESION POR CALOR

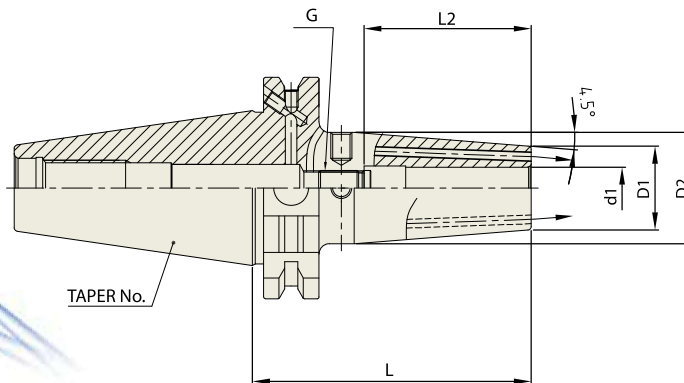
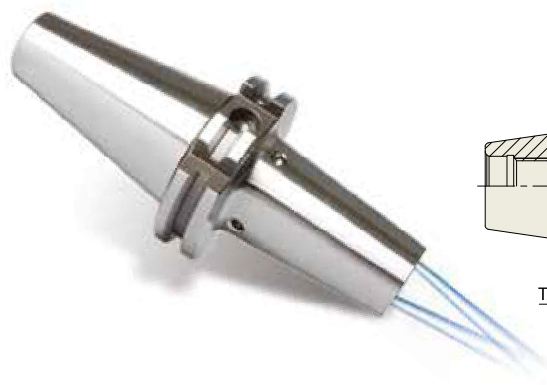

Unit : mm

TAPER No.	MODEL No.	EDP No.	d1	D1	D2	L	L2	G	WEIGHT (kg)
40	SK40AD/B-SFH6C-80	P2801301C	6	21	27	80	36	M5x0.8	1.10
	SK40AD/B-SFH6C-160	P2801302C	6	21	27	160	36	M5x0.8	1.15
	SK40AD/B-SFH8C-80	P2801303C	8	21	27	80	36	M6x1.0	1.11
	SK40AD/B-SFH8C-160	P2801304C	8	21	27	160	36	M6x1.0	1.15
	SK40AD/B-SFH10C-80	P2801305C	10	24	32	80	42	M8x1.0	1.10
	SK40AD/B-SFH10C-160	P2801306C	10	24	32	160	42	M8x1.0	1.15
	SK40AD/B-SFH12C-80	P2801307C	12	24	32	80	47	M10x1.0	1.10
	SK40AD/B-SFH12C-160	P2801308C	12	24	32	160	47	M10x1.0	1.15
	SK40AD/B-SFH14C-80	P2801309C	14	27	34	80	47	M10x1.0	1.20
	SK40AD/B-SFH14C-160	P2801310C	14	27	34	160	47	M10x1.0	1.50
	SK40AD/B-SFH16C-80	P2801311C	16	27	34	80	50	M12x1.0	1.20
	SK40AD/B-SFH16C-160	P2801312C	16	27	34	160	50	M12x1.0	1.50
	SK40AD/B-SFH18C-80	P2801313C	18	33	42	80	50	M12x1.0	1.30
	SK40AD/B-SFH18C-160	P2801314C	18	33	42	160	50	M12x1.0	1.60
	SK40AD/B-SFH20C-80	P2801315C	20	33	42	80	52	M16x1.0	1.40
	SK40AD/B-SFH20C-160	P2801316C	20	33	42	160	52	M16x1.0	1.70
	SK40AD/B-SFH25C-90	P2801317C	25	44	53	90	58	M16x1.0	1.70
SK40AD/B-SFH25C-160	P2801318C	25	44	53	160	58	M16x1.0	2.00	
50	SK50AD/B-SFH6C-80	P2801319C	6	21	27	80	36	M5x0.8	1.50
	SK50AD/B-SFH6C-160	P2801320C	6	21	27	160	36	M5x0.8	2.00
	SK50AD/B-SFH8C-80	P2801321C	8	21	27	80	36	M6x1.0	1.50
	SK50AD/B-SFH8C-160	P2801322C	8	21	27	160	36	M6x1.0	2.00
	SK50AD/B-SFH10C-80	P2801323C	10	24	32	80	42	M8x1.0	1.50
	SK50AD/B-SFH10C-160	P2801324C	10	24	32	160	42	M8x1.0	2.00
	SK50AD/B-SFH12C-80	P2801325C	12	24	32	80	47	M10x1.0	1.60
	SK50AD/B-SFH12C-160	P2801326C	12	24	32	160	47	M10x1.0	2.10
	SK50AD/B-SFH14C-80	P2801327C	14	27	34	80	47	M10x1.0	1.60
	SK50AD/B-SFH14C-160	P2801328C	14	27	34	160	47	M10x1.0	2.10
	SK50AD/B-SFH16C-80	P2801329C	16	27	34	80	50	M12x1.0	1.60
	SK50AD/B-SFH16C-160	P2801330C	16	27	34	160	50	M12x1.0	2.10
	SK50AD/B-SFH18C-80	P2801331C	18	33	42	80	50	M12x1.0	1.60
	SK50AD/B-SFH18C-160	P2801332C	18	33	42	160	50	M12x1.0	2.00
	SK50AD/B-SFH20C-80	P2801333C	20	33	42	80	52	M16x1.0	1.80
	SK50AD/B-SFH20C-160	P2801334C	20	33	42	160	52	M16x1.0	2.20
	SK50AD/B-SFH25C-90	P2801335C	25	44	53	90	58	M16x1.0	2.00
SK50AD/B-SFH25C-160	P2801336C	25	44	53	160	58	M16x1.0	2.40	

- ▶ CAT(ANSI B5.50) taper and Inch type products are available.
- ▶ Without balancing screw.
- ▶ Resealable Coolant Channel type is available upon request.

SHRINK FIT HOLDER (REINFORCED)

DIN 69871-SK

SCHRUMPFUTTER (VERSTÄRKT)
 MANDRIN DE FRETAGE (RENFORCÉ)
 MADRINI PER CALLETAMENTO A CALDO (RINFORZATO)
 PORTAHERRAMIENTAS DE COMPRESIÓN POR CALOR (REFORZADO)

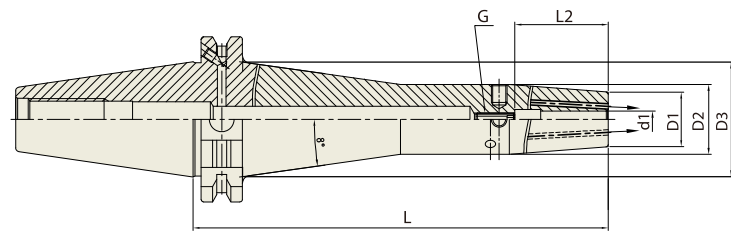

Unit : mm

TAPER No.	MODEL No.	EDP No.	d1	D1	D2	D3	L	L2	G	WEIGHT (kg)
40	SK40AD/B-SFH6C TW-160	P2801401TW	6	21	27	44.1	160	36	M5x0.8	1.56
	SK40AD/B-SFH8C TW-160	P2801402TW	8	21	27	44.1	160	36	M6x1.0	1.56
	SK40AD/B-SFH10C TW-160	P2801403TW	10	24	32	49.1	160	42	M8x1.0	1.78
	SK40AD/B-SFH12C TW-160	P2801404TW	12	24	32	49.1	160	47	M10x1.0	1.77
	SK40AD/B-SFH14C TW-160	P2801405TW	14	27	34	51.1	160	47	M10x1.0	1.74
	SK40AD/B-SFH16C TW-160	P2801406TW	16	27	34	51.1	160	50	M12x1.0	1.72
50	SK50AD/B-SFH6C TW-160	P2801407TW	6	21	27	44.1	160	36	M5x0.8	3.32
	SK50AD/B-SFH8C TW-160	P2801408TW	8	21	27	44.1	160	36	M6x1.0	3.32
	SK50AD/B-SFH10C TW-160	P2801409TW	10	24	32	49.1	160	42	M8x1.0	3.54
	SK50AD/B-SFH12C TW-160	P2801410TW	12	24	32	49.1	160	47	M10x1.0	3.54
	SK50AD/B-SFH14C TW-160	P2801411TW	14	27	34	51.1	160	47	M10x1.0	3.50
	SK50AD/B-SFH16C TW-160	P2801412TW	16	27	34	51.1	160	50	M12x1.0	3.48
	SK50AD/B-SFH20C TW-160	P2801413TW	20	33	42	59.1	160	52	M16x1.0	3.88

- ▶ CAT(ANSI B5.50) taper and Inch type products are available.
- ▶ Without balancing screw.



SHRINK FIT HOLDER

SFHS

SHRINK FIT HOLDER (EXTRA SLIM)

DIN 69893/
ISO 12164-1-HSK FORM A

SCHRUMPFUTTER
MANDRIN DE FRETTAGE
MADRINI PER CALLETAMENTO A CALDO
PORTAHERRAMIENTAS DE COMPRESION POR CALOR

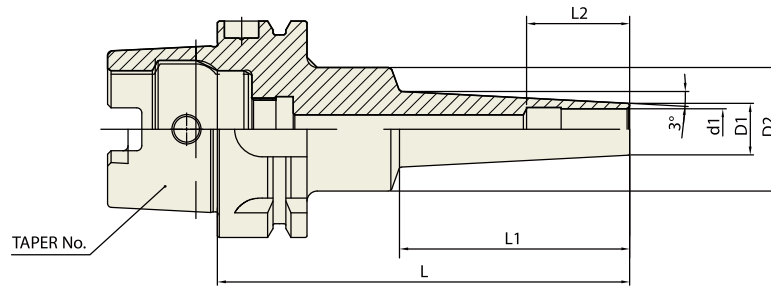

Unit : mm

TAPER No.	MODEL No.	EDP No.	d1	D1	D2	L	L1	L2	WEIGHT (kg)
40A	HSK40A-SFHS3-60	P2779801S	3	6	20	60	22	9	-
	HSK40A-SFHS3-90	P2779802S	3	6	20	80	42	9	-
	HSK40A-SFHS4-60	P2779803S	4	7	20	60	22	12	-
	HSK40A-SFHS4-90	P2779804S	4	7	20	80	42	12	-
	HSK40A-SFHS6-60	P2779805S	6	9	20	60	22	18	-
	HSK40A-SFHS6-90	P2779806S	6	9	20	80	42	18	-
50A	HSK50A-SFHS3-95	P2779807S	3	6	26	95	42	9	-
	HSK50A-SFHS3-120	P2779808S	3	6	26	120	67	9	-
	HSK50A-SFHS4-95	P2779809S	4	7	26	95	42	12	-
	HSK50A-SFHS4-120	P2779810S	4	7	26	120	67	12	-
	HSK50A-SFHS6-95	P2779811S	6	9	26	95	42	18	-
	HSK50A-SFHS6-120	P2779812S	6	9	26	120	67	18	-
	HSK50A-SFHS8-95	P2779813S	8	11	36	95	42	24	-
	HSK50A-SFHS8-120	P2779814S	8	11	36	120	67	24	-
	HSK50A-SFHS10-95	P2779815S	10	13	36	95	42	30	-
	HSK50A-SFHS10-120	P2779816S	10	13	36	120	67	30	-
63A	HSK63A-SFHS3-95	P2779817S	3	6	26	95	42	9	0.75
	HSK63A-SFHS3-120	P2779818S	3	6	26	120	67	9	0.77
	HSK63A-SFHS4-95	P2779819S	4	7	26	95	42	12	0.75
	HSK63A-SFHS4-120	P2779820S	4	7	26	120	67	12	0.78
	HSK63A-SFHS6-95	P2779821S	6	9	26	95	42	18	0.76
	HSK63A-SFHS6-120	P2779822S	6	9	26	120	97	18	0.78
	HSK63A-SFHS8-95	P2779823S	8	11	36	95	42	24	0.75
	HSK63A-SFHS8-160	P2779824S	8	11	36	160	97	24	0.97
	HSK63A-SFHS10-95	P2779825S	10	13	36	95	42	30	0.76
	HSK63A-SFHS10-160	P2779826S	10	13	36	160	97	30	1.00
	HSK63A-SFHS12-95	P2779827S	12	15	36	95	42	30	0.83
	HSK63A-SFHS12-160	P2779828S	12	15	36	160	97	30	1.04
100A	HSK100A-SFHS3-95	P2779829S	3	6	26	95	42	9	2.12
	HSK100A-SFHS3-120	P2779830S	3	6	26	120	67	9	2.14
	HSK100A-SFHS4-95	P2779831S	4	7	26	95	42	12	2.12
	HSK100A-SFHS4-120	P2779832S	4	7	26	120	67	12	2.14
	HSK100A-SFHS6-95	P2779833S	6	9	26	95	42	18	2.12
	HSK100A-SFHS6-120	P2779834S	6	9	26	120	67	18	2.15
	HSK100A-SFHS8-95	P2779835S	8	11	36	95	42	24	2.18
	HSK100A-SFHS8-160	P2779836S	8	11	36	160	97	24	2.33
	HSK100A-SFHS10-95	P2779837S	10	13	36	95	42	30	2.19
	HSK100A-SFHS10-160	P2779838S	10	13	36	160	97	30	2.34
	HSK100A-SFHS12-95	P2779839S	12	15	36	95	42	30	2.20
	HSK100A-SFHS12-160	P2779840S	12	15	36	160	97	30	2.38

► CAT(ANSI B5.50) taper and Inch type products are available.

SHRINK FIT HOLDER

SFH

SHRINK FIT HOLDER

DIN 69893/
ISO 12164-1-HSK FORM A

SCHRUMPFUTTER
MANDRIN DE FRETTAGE
MADRINI PER CALLETAMENTO A CALDO
PORTAHERRAMIENTAS DE COMPRESION POR CALOR

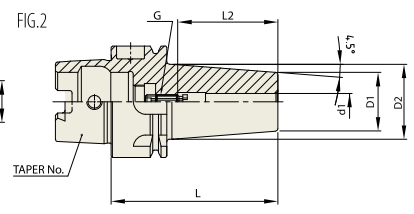
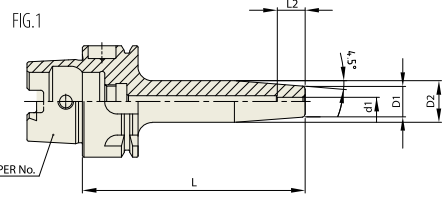

DIN 69893-HSK
2.5G
25,000 RPM
(at 3D) ≤ 3μm
AD

TAPER No.	MODEL No.	EDP No.	d1	D1	D2	L	L2	G	FIG.	WEIGHT (kg)
40A	HSK40A-SFH3-60	P2771408	3	11	15	60	10	-	1	0.30
	HSK40A-SFH3-80	P2771409	3	11	15	80	10	-	1	0.40
	HSK40A-SFH4-60	P2771410	4	11	15	60	12	-	1	0.30
	HSK40A-SFH4-80	P2771411	4	11	15	80	12	-	1	0.40
	HSK40A-SFH5-60	P2771412	5	11	15	60	15	-	1	0.30
	HSK40A-SFH5-80	P2771413	5	11	15	80	15	-	1	0.40
	HSK40A-SFH6-60	P2771414	6	21	27	60	36	M5×0.8	2	0.40
	HSK40A-SFH6-80	P2771415	6	21	27	80	36	M5×0.8	2	0.50
	HSK40A-SFH8-70	P2771416	8	21	27	70	36	M6×1.0	2	0.40
	HSK40A-SFH8-90	P2771417	8	21	27	90	36	M6×1.0	2	0.50
	HSK40A-SFH10-70	P2771418	10	24	32	70	42	M8×1.0	2	0.50
	HSK40A-SFH10-90	P2771419	10	24	32	90	42	M8×1.0	2	0.60

▶ Without balancing screw.

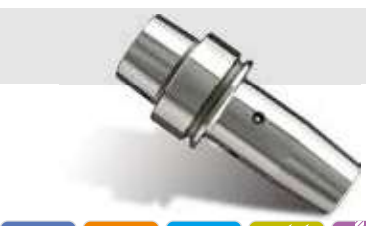

DIN 69893/
ISO 12164-1-HSK FORM E

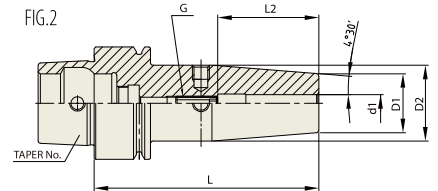
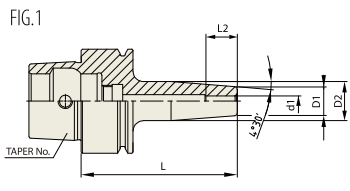

DIN 69893-HSK
2.5G
25,000 RPM
(at 3D) ≤ 3μm
AD

TAPER No.	MODEL No.	EDP No.	d1	D1	D2	L	L2	G	FIG.	WEIGHT (kg)
25E	HSK25E-SFH3-45	P2771420	3	11	15	45	10	-	1	-
	HSK25E-SFH4-45	P2771421	4	11	15	45	12	-	1	-
	HSK25E-SFH5-45	P2771422	5	11	15	45	15	-	1	-
	HSK25E-SFH6-45	P2771423	6	12	17	45	18	-	1	-
	HSK25E-SFH8-45	P2771424	8	14	18	45	30	-	1	-
	HSK25E-SFH10-50	P2771425	10	16	20	50	37	-	1	-
32E	HSK32E-SFH3-60	P2771426	3	11	15	60	10	-	1	-
	HSK32E-SFH4-60	P2771427	4	11	15	60	12	-	1	-
	HSK32E-SFH5-60	P2771428	5	11	15	60	15	-	1	-
	HSK32E-SFH6-70	P2771429	6	12	17	70	18	-	1	-
	HSK32E-SFH8-70	P2771430	8	14	18	70	30	-	1	-
	HSK32E-SFH10-80	P2771431	10	16	20	80	37	-	1	-
40E	HSK40E-SFH3-60	P2771432	3	11	15	60	10	-	1	0.30
	HSK40E-SFH3-80	P2771433	3	11	15	80	10	-	1	0.40
	HSK40E-SFH4-60	P2771434	4	11	15	60	12	-	1	0.30
	HSK40E-SFH4-80	P2771435	4	11	15	80	12	-	1	0.40
	HSK40E-SFH5-60	P2771436	5	11	15	60	15	-	1	0.30
	HSK40E-SFH5-80	P2771437	5	11	15	80	15	-	1	0.40
	HSK40E-SFH6-60	P2771438	6	21	27	60	36	M5×0.8	2	0.40
	HSK40E-SFH6-80	P2771439	6	21	27	80	36	M5×0.8	2	0.50
	HSK40E-SFH8-70	P2771440	8	21	27	70	36	M6×1.0	2	0.40
	HSK40E-SFH8-90	P2771441	8	21	27	90	36	M6×1.0	2	0.50
	HSK40E-SFH10-70	P2771442	10	24	32	70	42	M8×1.0	2	0.50
	HSK40E-SFH10-90	P2771443	10	24	32	90	42	M8×1.0	2	0.60

▶ Without balancing screw.



SHRINK FIT HOLDER

SFH

SHRINK FIT HOLDER

SCHRUMPFUTTER
MANDRIN DE FRETTAGE
MADRINI PER CALLETAMENTO A CALDO
PORTAHERRAMIENTAS DE COMPRESION POR CALOR

DIN 69893/
ISO 12164-1-HSK FORM A

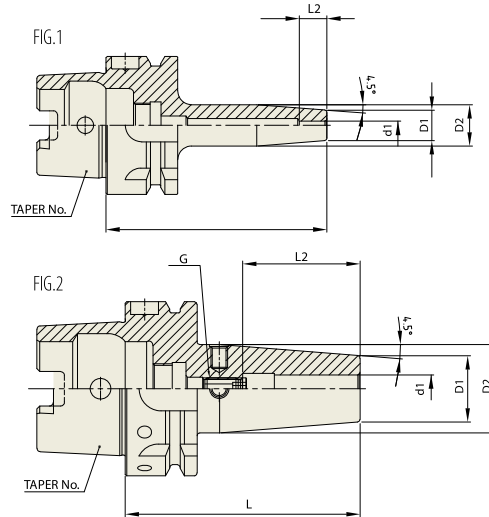

Unit : mm

TAPER No.	MODEL No.	EDP No.	d1	D1	D2	L	L2	G	FIG.	WEIGHT (kg)
50A	HSK50A-SFH3-80	P2771444	3	11	15	80	10	-	1	0.54
	HSK50A-SFH4-80	P2771445	4	11	15	80	12	-	1	0.55
	HSK50A-SFH5-80	P2771446	5	11	15	80	15	-	1	0.56
	HSK50A-SFH6-80	P2776901	6	21	27	80	36	M5×0.8	2	0.57
	HSK50A-SFH8-80	P2771447	8	21	27	80	36	M6×1.0	2	0.58
	HSK50A-SFH10-85	P2771448	10	24	32	85	42	M8×1.0	2	0.65
	HSK50A-SFH12-90	P2771449	12	24	32	90	47	M10×1.0	2	0.67
	HSK50A-SFH14-90	P2771450	14	27	34	90	47	M10×1.0	2	0.72
	HSK50A-SFH16-95	P2771451	16	27	34	95	50	M12×1.0	2	0.73
	HSK50A-SFH18-95	P2771452	18	33	42	95	50	M12×1.0	2	0.90
63A	HSK50A-SFH20-100	P2771453	20	33	42	100	52	M16×1.0	2	0.92
	HSK63A-SFH3-80	P2771401	3	11	15	80	10	-	1	0.70
	HSK63A-SFH4-80	P2771402	4	11	15	80	12	-	1	0.70
	HSK63A-SFH5-80	P2771403	5	11	15	80	15	-	1	0.70
	HSK63A-SFH6-80	P2565057	6	21	27	80	36	M5×0.8	2	0.83
	HSK63A-SFH6-160	P2771404	6	21	27	160	36	M5×0.8	2	1.00
	HSK63A-SFH8-80	P2600007	8	21	27	80	36	M6×1.0	2	0.83
	HSK63A-SFH8-160	P2771405	8	21	27	160	36	M6×1.0	2	1.00
	HSK63A-SFH10-85	P2565052	10	24	32	85	42	M8×1.0	2	0.83
	HSK63A-SFH10-160	P2771406	10	24	32	160	42	M8×1.0	2	1.00
	HSK63A-SFH12-90	P2600003	12	24	32	90	47	M10×1.0	2	0.83
	HSK63A-SFH12-160	P2771407	12	24	32	160	47	M10×1.0	2	1.00
	HSK63A-SFH14-90	P2771454	14	27	34	90	47	M10×1.0	2	0.91
	HSK63A-SFH14-160	P2771455	14	27	34	160	47	M10×1.0	2	1.30
	HSK63A-SFH16-95	P2565054	16	27	34	95	50	M12×1.0	2	0.98
	HSK63A-SFH16-160	P2565053	16	27	34	160	50	M12×1.0	2	1.40
	HSK63A-SFH18-95	P2771456	18	33	42	95	50	M12×1.0	2	0.98
	HSK63A-SFH18-160	P2771457	18	33	42	160	50	M12×1.0	2	1.40
	HSK63A-SFH20-100	P2600005	20	33	42	100	52	M16×1.0	2	1.00
	HSK63A-SFH20-160	P2565055	20	33	42	160	52	M16×1.0	2	1.40
HSK63A-SFH25-115	P2771458	25	44	53	115	58	M16×1.0	2	1.40	
HSK63A-SFH25-160	P2771459	25	44	53	160	58	M16×1.0	2	1.80	

▶ Without balancing screw.

SHRINK FIT HOLDER

**DIN 69893/
ISO 12164-1-HSK FORM A**

SCHRUMPFUTTER
MANDRIN DE FRETTAGE
MADRINI PER CALLETAMENTO A CALDO
PORTAHERRAMIENTAS DE COMPRESION POR CALOR

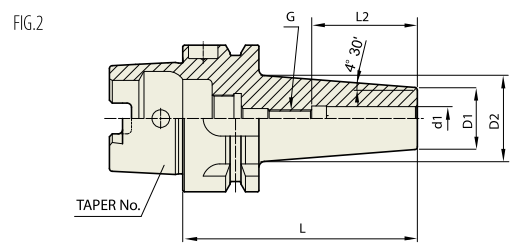
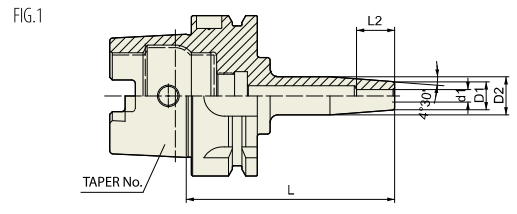

DIN 69893-HSK
2.5G
25,000 RPM
(at 3D) ≤3μm
AD

Unit : mm

TAPER No.	MODEL No.	EDP No.	d1	D1	D2	L	L2	G	FIG.	WEIGHT (kg)
80A	HSK80A-SFH6-85	P2771460	6	21	27	85	36	M5x0.8	1	
	HSK80A-SFH8-85	P2771461	8	21	27	85	36	M6x1.0	1	
	HSK80A-SFH10-90	P2771462	10	24	32	90	41	M8x1.0	2	
	HSK80A-SFH12-95	P2771463	12	24	32	95	46	M10x1.0	2	
	HSK80A-SFH14-95	P2771464	14	27	34	95	46	M10x1.0	2	
	HSK80A-SFH16-100	P2771465	16	27	34	100	49	M12x1.0	2	
	HSK80A-SFH18-100	P2771466	18	33	42	100	49	M12x1.0	2	
	HSK80A-SFH20-105	P2771467	20	33	42	105	51	M16x1.0	2	
	HSK80A-SFH25-115	P2771468	25	44	53	115	57	M16x1.0	2	
	100A	HSK100A-SFH3-85	P2771469	3	11	15	85	10	-	1
HSK100A-SFH4-85		P2771470	4	11	15	85	12	-	1	1.30
HSK100A-SFH5-85		P2771471	5	11	15	85	15	-	1	1.30
HSK100A-SFH6-85		P2777301	6	21	27	85	36	M5x0.8	1	1.30
HSK100A-SFH6-160		P2771472	6	21	27	160	36	M5x0.8	1	1.80
HSK100A-SFH8-85		P2777302	8	21	27	85	36	M6x1.0	1	1.30
HSK100A-SFH8-160		P2771473	8	21	27	160	36	M6x1.0	1	1.80
HSK100A-SFH10-90		P2777303	10	24	32	90	42	M8x1.0	1	1.30
HSK100A-SFH10-160		P2771474	10	24	32	160	42	M8x1.0	1	1.80
HSK100A-SFH12-95		P2777304	12	24	32	95	47	M10x1.0	1	1.30
HSK100A-SFH12-160		P2771475	12	24	32	160	47	M10x1.0	1	1.80
HSK100A-SFH14-95		P2771476	14	27	34	95	47	M10x1.0	1	1.40
HSK100A-SFH14-160		P2771477	14	27	34	160	47	M10x1.0	1	1.90
HSK100A-SFH16-100		P2771478	16	27	34	100	50	M12x1.0	1	1.40
HSK100A-SFH16-160		P2771479	16	27	34	160	50	M12x1.0	1	1.90
HSK100A-SFH18-100		P2771480	18	33	42	100	50	M12x1.0	2	1.50
HSK100A-SFH18-160		P2771481	18	33	42	160	50	M12x1.0	2	2.00
HSK100A-SFH20-100		P2771482	20	33	42	100	52	M16x1.0	2	1.50
HSK100A-SFH20-160		P2771483	20	33	42	160	52	M16x1.0	2	2.00
HSK100A-SFH25-115		P2771484	25	44	53	115	58	M16x1.0	2	1.80
HSK100A-SFH25-160	P2771485	25	44	53	160	58	M16x1.0	2	2.30	

▶ Without balancing screw.



SHRINK FIT HOLDER

SFH

SHRINK FIT HOLDER (COOLANT CHANNEL)

DIN 69893/
ISO 12164-1-HSK FORM A

SCHRUMPFUTTER

MANDRIN DE FRETAGE

MADRINI PER CALLETAMENTO A CALDO

PORTAHERRAMIENTAS DE COMPRESION POR CALOR

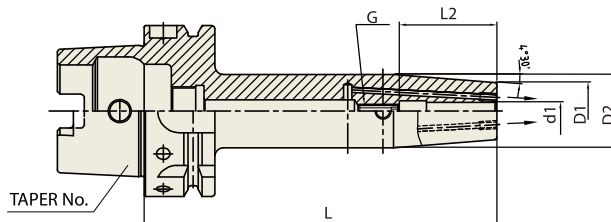

Unit : mm

TAPER No.	MODEL No.	EDP No.	d1	D1	D2	L	L2	G	WEIGHT (kg)
63A	HSK63A-SFH6C-80	P2862013C	6	21	27	80	36	M5x0.8	0.83
	HSK63A-SFH6C-160	P2862014C	6	21	27	160	36	M5x0.8	1.00
	HSK63A-SFH8C-80	P2862015C	8	21	27	80	36	M6x1.0	0.83
	HSK63A-SFH8C-160	P2862016C	8	21	27	160	36	M6x1.0	1.00
	HSK63A-SFH10C-85	P2862017C	10	24	32	85	42	M8x1.0	0.83
	HSK63A-SFH10C-160	P2862018C	10	24	32	160	42	M8x1.0	1.00
	HSK63A-SFH12C-90	P2862019C	12	24	32	90	47	M10x1.0	0.83
	HSK63A-SFH12C-160	P2862020C	12	24	32	160	47	M10x1.0	1.00
	HSK63A-SFH14C-90	P2862021C	14	27	34	90	47	M10x1.0	0.91
	HSK63A-SFH14C-160	P2862022C	14	27	34	160	47	M10x1.0	1.30
	HSK63A-SFH16C-95	P2862023C	16	27	34	95	50	M12x1.0	0.98
	HSK63A-SFH16C-160	P2862024C	16	27	34	160	50	M12x1.0	1.40
	HSK63A-SFH18C-95	P2862025C	18	33	42	95	50	M12x1.0	0.98
	HSK63A-SFH18C-160	P2862026C	18	33	42	160	50	M12x1.0	1.40
	HSK63A-SFH20C-100	P2862027C	20	33	42	100	52	M16x1.0	1.00
	HSK63A-SFH20C-160	P2862028C	20	33	42	160	52	M16x1.0	1.40
	HSK63A-SFH25C-115	P2862029C	25	44	53	115	58	M16x1.0	1.40
	HSK63A-SFH25C-160	P2862030C	25	44	53	160	58	M16x1.0	1.80
100A	HSK100A-SFH6C-85	P2862031C	6	21	27	85	36	M5x0.8	1.30
	HSK100A-SFH6C-160	P2862032C	6	21	27	160	36	M5x0.8	1.80
	HSK100A-SFH8C-85	P2862033C	8	21	27	85	36	M6x1.0	1.30
	HSK100A-SFH8C-160	P2862034C	8	21	27	160	36	M6x1.0	1.80
	HSK100A-SFH10C-90	P2862035C	10	24	32	90	42	M8x1.0	1.30
	HSK100A-SFH10C-160	P2862036C	10	24	32	160	42	M8x1.0	1.80
	HSK100A-SFH12C-95	P2862037C	12	24	32	95	47	M10x1.0	1.30
	HSK100A-SFH12C-160	P2862038C	12	24	32	160	47	M10x1.0	1.80
	HSK100A-SFH14C-95	P2862039C	14	27	34	95	47	M10x1.0	1.40
	HSK100A-SFH14C-160	P2862040C	14	27	34	160	47	M10x1.0	1.90
	HSK100A-SFH16C-100	P2862041C	16	27	34	100	50	M12x1.0	1.40
	HSK100A-SFH16C-160	P2862042C	16	27	34	160	50	M12x1.0	1.90
	HSK100A-SFH18C-100	P2862043C	18	33	42	100	50	M12x1.0	1.50
	HSK100A-SFH18C-160	P2862044C	18	33	42	160	50	M12x1.0	2.00
	HSK100A-SFH20C-100	P2862045C	20	33	42	100	52	M16x1.0	1.50
	HSK100A-SFH20C-160	P2862046C	20	33	42	160	52	M16x1.0	2.00
	HSK100A-SFH25C-115	P2862047C	25	44	53	115	58	M16x1.0	1.80
	HSK100A-SFH25C-160	P2862048C	25	44	53	160	58	M16x1.0	2.30

- ▶ CAT(ANSI B5.50) taper and Inch type products are available.
- ▶ Without balancing screw.
- ▶ Resealable Coolant Channel type is available upon request.

SHRINK FIT HOLDER (REINFORCED)

**DIN 69893/
ISO 12164-1-HSK FORM A**

SCHRUMPFUTTER (VERSTÄRKT)
MANDRIN DE FRETAGE (RENFORCÉ)
MADRINI PER CALLETAMENTO A CALDO (RINFORZATO)
PORTAHERRAMIENTAS DE COMPRESION POR CALOR (REFORZADO)

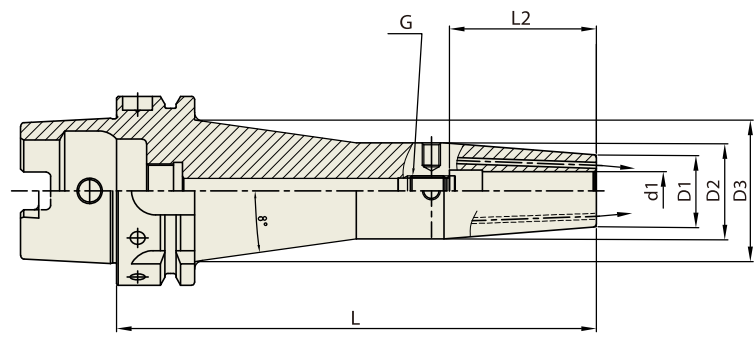

Unit : mm										
TAPER No.	MODEL No.	EDP No.	d1	D1	D2	D3	L	L2	G	WEIGHT (kg)
63A	HSK63A-SFH6C TW-160	P2801501TW	6	21	27	42.2	160	36	M5x0.8	1.36
	HSK63A-SFH8C TW-160	P2801502TW	8	21	27	42.2	160	36	M6x1.0	1.35
	HSK63A-SFH10C TW-160	P2801503TW	10	24	32	47.2	160	42	M8x1.0	1.56
	HSK63A-SFH12C TW-160	P2801504TW	12	24	32	47.2	160	47	M10x1.0	1.55
	HSK63A-SFH14C TW-160	P2801505TW	14	27	34	49.2	160	47	M10x1.0	1.52
	HSK63A-SFH16C TW-160	P2801506TW	16	27	34	49.2	160	50	M12x1.0	1.64
100A	HSK100A-SFH6C TW-160	P2801507TW	6	21	27	41.3	160	36	M5x0.8	2.73
	HSK100A-SFH8C TW-160	P2801508TW	8	21	27	41.3	160	36	M6x1.0	2.72
	HSK100A-SFH10C TW-160	P2801509TW	10	24	32	46.3	160	42	M8x1.0	2.92
	HSK100A-SFH12C TW-160	P2801510TW	12	24	32	46.3	160	47	M10x1.0	2.90
	HSK100A-SFH14C TW-160	P2801511TW	14	27	34	48.3	160	47	M10x1.0	3.05
	HSK100A-SFH16C TW-160	P2801512TW	16	27	34	48.3	160	50	M12x1.0	3.03
	HSK100A-SFH18C TW-160	P2801513TW	18	33	42	56.3	160	50	M12x1.0	3.39
	HSK100A-SFH20C TW-160	P2801514TW	20	33	42	56.3	160	52	M16x1.0	3.36

- ▶ CAT(ANSI B5.50) taper and Inch type products are available.
- ▶ Without balancing screw.



SHRINK FIT HOLDER

SFH

SHRINK FIT HOLDER

SCHRUMPFUTTER
 MANDRIN DE FRETTAGE
 MADRINI PER CALLETAMENTO A CALDO
 PORTAHERRAMIENTAS DE COMPRESION POR CALOR

CBT (BT DUAL CONTACT)

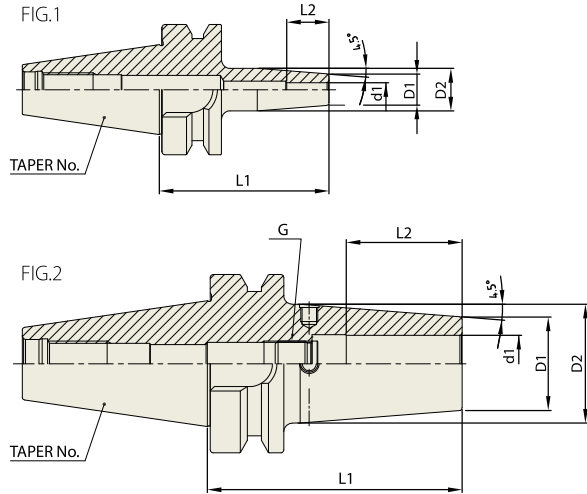

TAPER No.	MODEL No.	EDP No.	d1	D1	D2	L	L2	G	FIG.	WEIGHT (kg)
30	CBT30-SFH3-60	P2771505	3	11	15	60	10	-	1	0.40
	CBT30-SFH4-60	P2771506	4	11	15	60	12	-	1	0.40
	CBT30-SFH5-60	P2771507	5	11	15	60	15	-	1	0.40
	CBT30-SFH6-60	P2771508	6	21	27	60	36	M5×0.8	2	0.40
	CBT30-SFH8-60	P2771509	8	21	27	60	36	M6×1.0	2	0.40
	CBT30-SFH10-80	P2771510	10	24	32	80	41	M8×1.0	2	0.40
	CBT30-SFH12-80	P2771511	12	24	32	80	48	M10×1.0	2	0.42
	CBT30-SFH14-80	P2771512	14	27	34	80	48	M10×1.0	2	
	CBT30-SFH16-80	P2771513	16	27	34	80	51	M12×1.0	2	0.42
	CBT30-SFH18-80	P2771514	18	27	34	80	51	M12×1.0	2	
CBT30-SFH20-90	P2771515	20	33	42	90	53	M16×1.0	2	0.44	
40	CBT40-SFH3-90	P2771516	3	11	15	90	10	-	1	1.00
	CBT40-SFH4-90	P2771517	4	11	15	90	12	-	1	1.00
	CBT40-SFH5-90	P2771518	5	11	15	90	23	-	1	1.00
	CBT40-SFH6-90	P2771519	6	21	27	90	36	M5×0.8	2	1.10
	CBT40-SFH6-160	P2771520	6	21	27	160	36	M5×0.8	2	1.15
	CBT40-SFH8-90	P2771501	8	21	27	90	36	M6×1.0	2	1.11
	CBT40-SFH8-160	P2771521	8	21	27	160	36	M6×1.0	2	1.15
	CBT40-SFH10-90	P2771502	10	24	32	90	41	M8×1.0	2	1.10
	CBT40-SFH10-160	P2771522	10	24	32	160	41	M8×1.0	2	1.15
	CBT40-SFH12-90	P2771503	12	24	32	90	47	M10×1.0	2	1.10
	CBT40-SFH12-160	P2771523	12	24	32	160	47	M10×1.0	2	1.15
	CBT40-SFH14-90	P2771524	14	27	34	90	47	M10×1.0	2	1.20
	CBT40-SFH14-160	P2771525	14	27	34	160	47	M10×1.0	2	1.50
	CBT40-SFH16-90	P2771526	16	27	34	90	50	M12×1.0	2	1.20
	CBT40-SFH16-160	P2771527	16	27	34	160	50	M12×1.0	2	1.50
	CBT40-SFH18-90	P2771528	18	33	42	90	50	M12×1.0	2	1.30
	CBT40-SFH18-160	P2771529	18	33	42	160	50	M12×1.0	2	1.60
	CBT40-SFH20-90	P2771504	20	33	42	90	52	M16×1.0	2	1.40
	CBT40-SFH20-160	P2771530	20	33	42	160	52	M16×1.0	2	1.70
	CBT40-SFH25-100	P2771531	25	44	53	100	58	M16×1.0	2	1.70
	CBT40-SFH25-160	P2771532	25	44	53	160	58	M16×1.0	2	2.00

▶ Without balancing screw.

SHRINK FIT HOLDER

CBT (BT DUAL CONTACT)

SCHRUMPFUTTER
MANDRIN DE FRETTAGE
MADRINI PER CALLETAMENTO A CALDO
PORTAHERRAMIENTAS DE COMPRESION POR CALOR

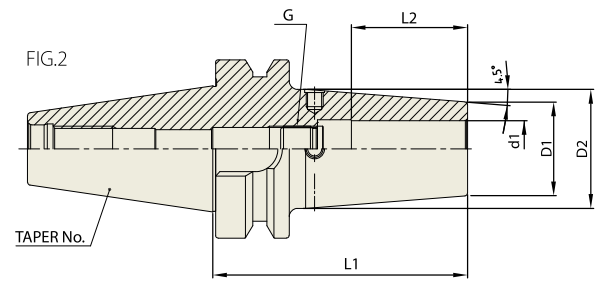
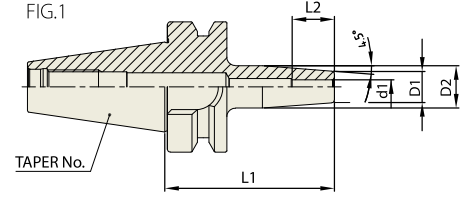

Unit : mm

TAPER No.	MODEL No.	EDP No.	d1	D1	D2	L	L2	G	FIG.	WEIGHT (kg)
50	CBT50-SFH3-100	P2771533	3	11	15	100	10	-	1	1.50
	CBT50-SFH4-100	P2771534	4	11	15	100	12	-	1	1.50
	CBT50-SFH5-100	P2771535	5	11	15	100	15	-	1	1.50
	CBT50-SFH6-100	P2771536	6	21	27	100	36	M5×0.8	2	1.50
	CBT50-SFH6-160	P2771537	6	21	27	160	36	M5×0.8	2	2.00
	CBT50-SFH8-100	P2771538	8	21	27	100	36	M6×1.0	2	1.50
	CBT50-SFH8-160	P2771539	8	21	27	160	36	M6×1.0	2	2.00
	CBT50-SFH10-100	P2771540	10	24	32	100	42	M8×1.0	2	1.50
	CBT50-SFH10-160	P2771541	10	24	32	160	42	M8×1.0	2	2.00
	CBT50-SFH12-100	P2771542	12	24	32	100	47	M10×1.0	2	1.50
	CBT50-SFH12-160	P2771543	12	24	32	160	47	M10×1.0	2	2.00
	CBT50-SFH14-100	P2771544	14	27	34	100	47	M10×1.0	2	1.60
	CBT50-SFH14-160	P2771545	14	27	34	160	47	M10×1.0	2	2.10
	CBT50-SFH16-100	P2771546	16	27	34	100	50	M12×1.0	2	1.60
	CBT50-SFH16-160	P2771547	16	27	34	160	50	M12×1.0	2	2.10
	CBT50-SFH18-100	P2771548	18	33	42	100	50	M12×1.0	2	1.60
	CBT50-SFH18-160	P2771549	18	33	42	160	50	M12×1.0	2	2.00
	CBT50-SFH20-100	P2771550	20	33	42	100	52	M16×1.0	2	1.80
	CBT50-SFH20-160	P2771551	20	33	42	160	52	M16×1.0	2	2.20
	CBT50-SFH25-100	P2771552	25	44	53	100	58	M16×1.0	2	2.00
CBT50-SFH25-160	P2771553	25	44	53	160	58	M16×1.0	2	2.40	

► Without balancing screw.



SHRINK FIT HOLDER

SFH

SHRINK FIT HOLDER (COOLANT CHANNEL)

SCHRUMPFUTTER
MANDRIN DE FRETTAGE
MADRINI PER CALLETAMENTO A CALDO
PORTAHERRAMIENTAS DE COMPRESION POR CALOR

CBT
(BT DUAL CONTACT)

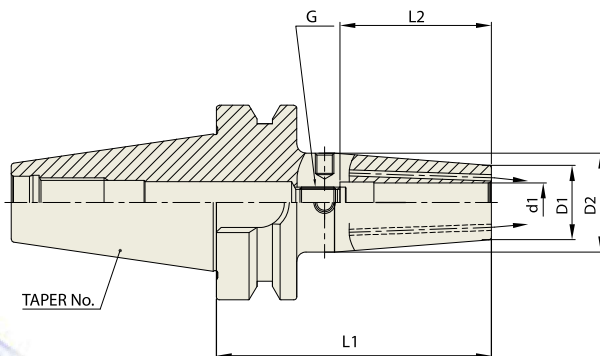

Unit : mm

TAPER No.	MODEL No.	EDP No.	d1	D1	D2	L	L2	G	WEIGHT (kg)
40	CBT40-SFH6C-90	P2862049C	6	21	27	90	36	M5x0.8	1.10
	CBT40-SFH6C-160	P2862050C	6	21	27	160	36	M5x0.8	1.15
	CBT40-SFH8C-90	P2862051C	8	21	27	90	36	M6x1.0	1.11
	CBT40-SFH8C-160	P2862052C	8	21	27	160	36	M6x1.0	1.15
	CBT40-SFH10C-90	P2862053C	10	24	32	90	41	M8x1.0	1.10
	CBT40-SFH10C-160	P2862054C	10	24	32	160	41	M8x1.0	1.15
	CBT40-SFH12C-90	P2862055C	12	24	32	90	47	M10x1.0	1.10
	CBT40-SFH12C-160	P2862056C	12	24	32	160	47	M10x1.0	1.15
	CBT40-SFH14C-90	P2862057C	14	27	34	90	47	M10x1.0	1.20
	CBT40-SFH14C-160	P2862058C	14	27	34	160	47	M10x1.0	1.50
	CBT40-SFH16C-90	P2862059C	16	27	34	90	50	M12x1.0	1.20
	CBT40-SFH16C-160	P2862060C	16	27	34	160	50	M12x1.0	1.50
	CBT40-SFH18C-90	P2862061C	18	33	42	90	50	M12x1.0	1.30
	CBT40-SFH18C-160	P2862062C	18	33	42	160	50	M12x1.0	1.60
	CBT40-SFH20C-90	P2862063C	20	33	42	90	52	M16x1.0	1.40
	CBT40-SFH20C-160	P2862064C	20	33	42	160	52	M16x1.0	1.70
50	CBT50-SFH25C-100	P2862065C	25	44	53	100	58	M16x1.0	1.70
	CBT50-SFH25C-160	P2862066C	25	44	53	160	58	M16x1.0	2.00
	CBT50-SFH6C-100	P2862067C	6	21	27	100	36	M5x0.8	1.50
	CBT50-SFH6C-160	P2862068C	6	21	27	160	36	M5x0.8	2.00
	CBT50-SFH8C-100	P2862069C	8	21	27	100	36	M6x1.0	1.50
	CBT50-SFH8C-160	P2862070C	8	21	27	160	36	M6x1.0	2.00
	CBT50-SFH10C-100	P2862071C	10	24	32	100	42	M8x1.0	1.10
	CBT50-SFH10C-160	P2862072C	10	24	32	160	42	M8x1.0	1.15
	CBT50-SFH12C-100	P2862073C	12	24	32	100	47	M10x1.0	1.60
	CBT50-SFH12C-160	P2862074C	12	24	32	160	47	M10x1.0	2.10
	CBT50-SFH14C-100	P2862075C	14	27	34	100	47	M10x1.0	1.60
	CBT50-SFH14C-160	P2862076C	14	27	34	160	47	M10x1.0	2.10
	CBT50-SFH16C-100	P2862077C	16	27	34	100	50	M12x1.0	1.60
	CBT50-SFH16C-160	P2862078C	16	27	34	160	50	M12x1.0	2.10
	CBT50-SFH18C-100	P2862079C	18	33	42	100	50	M12x1.0	1.60
	CBT50-SFH18C-160	P2862080C	18	33	42	160	50	M12x1.0	2.00
CBT50-SFH20C-100	P2862081C	20	33	42	100	52	M16x1.0	1.80	
CBT50-SFH20C-160	P2862082C	20	33	42	160	52	M16x1.0	2.20	
CBT50-SFH25C-100	P2862083C	25	44	53	100	58	M16x1.0	2.00	
CBT50-SFH25C-160	P2862084C	25	44	53	160	58	M16x1.0	2.40	

- ▶ Without balancing screw.
- ▶ Two Coolant Bores are a standard design for Coolant Channel type.
- ▶ Resealable Coolant Channel type is available upon request.



SHRINK FIT HOLDER

SFHS

SHRINK FIT HOLDER (EXTRA SLIM)

SCHRUMPFUTTER
MANDRIN DE FRETTAGE
MADRINI PER CALLETAMENTO A CALDO
PORTAHERRAMIENTAS DE COMPRESION POR CALOR

JIS B6339/
MAS 403-BT

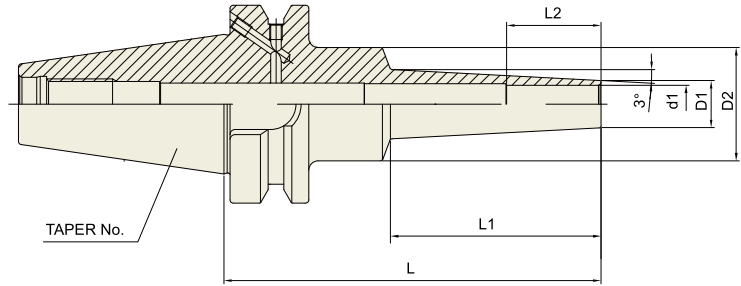

Unit : mm

TAPER No.	MODEL No.	EDP No.	d1	D1	D2	L	L1	L2	WEIGHT (kg)
30	BT30-SFHS3-60	P2779851S	3	6	20	60	22	9	
	BT30-SFHS3-80	P2779852S	3	6	20	80	42	9	
	BT30-SFHS3-120	P2779853S	3	6	20	120	67	9	
	BT30-SFHS4-60	P2779854S	4	7	20	60	22	12	
	BT30-SFHS4-80	P2779855S	4	7	20	80	42	12	
	BT30-SFHS4-120	P2779856S	4	7	20	120	67	12	
	BT30-SFHS6-60	P2779857S	6	9	20	60	22	18	
	BT30-SFHS6-80	P2779858S	6	9	20	80	42	18	
40	BT30-SFHS6-120	P2779859S	6	9	20	120	67	18	
	BT40AD/B-SFHS3-95	P2779860S	3	6	26	95	42	9	
	BT40AD/B-SFHS3-120	P2779861S	3	6	26	120	67	9	
	BT40AD/B-SFHS3-160	P2779862S	3	6	26	160	97	9	
	BT40AD/B-SFHS4-95	P2779863S	4	7	26	95	42	12	
	BT40AD/B-SFHS4-120	P2779864S	4	7	26	120	67	12	
	BT40AD/B-SFHS4-160	P2779865S	4	7	26	160	97	12	
	BT40AD/B-SFHS6-95	P2779866S	6	9	26	95	42	18	
	BT40AD/B-SFHS6-120	P2779867S	6	9	26	120	67	18	
	BT40AD/B-SFHS6-160	P2779868S	6	9	26	160	97	18	
	BT40AD/B-SFHS8-95	P2779869S	8	11	36	95	42	24	
	BT40AD/B-SFHS8-120	P2779870S	8	11	36	120	67	24	
	BT40AD/B-SFHS8-160	P2779871S	8	11	36	160	97	24	
	BT40AD/B-SFHS10-95	P2779872S	10	13	36	95	42	30	
	BT40AD/B-SFHS10-120	P2779873S	10	13	36	120	67	30	
	BT40AD/B-SFHS10-160	P2779874S	10	13	36	160	97	30	
	BT40AD/B-SFHS12-95	P2779875S	12	15	36	95	42	30	
	BT40AD/B-SFHS12-120	P2779876S	12	15	36	120	67	30	
	BT40AD/B-SFHS12-160	P2779877S	12	15	36	160	97	30	
	50	BT50AD/B-SFHS3-110	P2779878S	3	6	26	110	42	9
BT50AD/B-SFHS3-160		P2779879S	3	6	26	160	97	9	
BT50AD/B-SFHS4-110		P2779880S	4	7	26	110	42	12	
BT50AD/B-SFHS4-160		P2779881S	4	7	26	160	97	12	
BT50AD/B-SFHS6-110		P2779882S	6	9	26	110	42	18	
BT50AD/B-SFHS6-160		P2779883S	6	9	26	160	97	18	
BT50AD/B-SFHS8-110		P2779884S	8	11	36	110	42	24	
BT50AD/B-SFHS8-160		P2779885S	8	11	36	160	97	24	
BT50AD/B-SFHS10-110		P2779886S	10	13	36	110	42	30	
BT50AD/B-SFHS10-160		P2779887S	10	13	36	160	97	30	
BT50AD/B-SFHS12-110		P2779888S	12	15	36	110	42	30	
BT50AD/B-SFHS12-160		P2779889S	12	15	36	160	97	30	

- ▶ CBT(BT DUAL CONTACT) Holder available.
- ▶ CAT(ANSI B5.50) taper and Inch type products are available.



SHRINK FIT HOLDER

SFH

SHRINK FIT HOLDER

SCHRUMPFUTTER
MANDRIN DE FRETTAGE
MADRINI PER CALLETAMENTO A CALDO
PORTAHERRAMIENTAS DE COMPRESION POR CALOR

JIS B6339/ MAS 403-BT

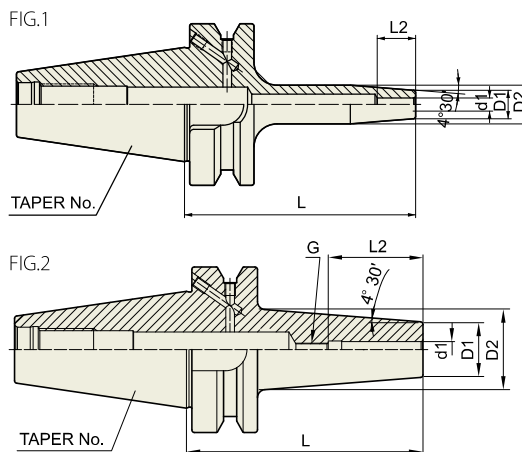

Unit : mm

TAPER No.	MODEL No.	EDP No.	d1	D1	D2	L	L2	G	FIG.	WEIGHT (kg)
30	BT30AD/B-SFH3-60	P2776703	3	11	15	60	10	-	1	0.40
	BT30AD/B-SFH4-60	P2776702	4	11	15	60	12	-	1	0.40
	BT30AD/B-SFH5-60	P2776704	5	11	15	60	15	-	1	0.40
	BT30AD/B-SFH6-60	P2776701	6	21	27	60	36	M5×0.8	2	0.40
	BT30AD/B-SFH8-60	P2776705	8	21	27	60	36	M6×1.0	2	0.40
	BT30AD/B-SFH10-80	P2776706	10	24	32	80	42	M8×1.0	2	0.40
	BT30AD/B-SFH12-80	P2776707	12	24	32	80	47	M10×1.0	2	0.42
	BT30AD/B-SFH14-80	P2776708	14	27	34	80	47	M10×1.0	2	
	BT30AD/B-SFH16-80	P2776709	16	27	34	80	50	M12×1.0	2	0.42
	BT30AD/B-SFH18-80	P2776710	18	33	42	80	50	M12×1.0	2	
BT30AD/B-SFH20-90	P2776711	20	33	42	90	52	M16×1.0	2	0.44	
40	BT40AD/B-SFH3-90	P2776712	3	11	15	90	10	-	1	1.00
	BT40AD/B-SFH4-90	P2776713	4	11	15	90	12	-	1	1.00
	BT40AD/B-SFH5-90	P2776714	5	11	15	90	15	-	1	1.00
	BT40AD/B-SFH6-90	P2771601	6	21	27	90	36	M5×0.8	2	1.10
	BT40AD/B-SFH6-160	P2771602	6	21	27	160	36	M5×0.8	2	1.15
	BT40AD/B-SFH8-90	P2771603	8	21	27	90	36	M6×1.0	2	1.11
	BT40AD/B-SFH8-160	P2771604	8	21	27	160	36	M6×1.0	2	1.15
	BT40AD/B-SFH10-90	P2771605	10	24	32	90	42	M8×1.0	2	1.10
	BT40AD/B-SFH10-160	P2771606	10	24	32	160	42	M8×1.0	2	1.15
	BT40AD/B-SFH12-90	P2771607	12	24	32	90	47	M10×1.0	2	1.10
	BT40AD/B-SFH12-160	P2771608	12	24	32	160	47	M10×1.0	2	1.15
	BT40AD/B-SFH14-90	P2771611	14	27	34	90	47	M10×1.0	2	1.20
	BT40AD/B-SFH14-160	P2771612	14	27	34	160	47	M10×1.0	2	1.50
	BT40AD/B-SFH16-90	P2771609	16	27	34	90	50	M12×1.0	2	1.20
	BT40AD/B-SFH16-160	P2771610	16	27	34	160	50	M12×1.0	2	1.50
	BT40AD/B-SFH18-90	P2771613	18	33	42	90	50	M12×1.0	2	1.30
	BT40AD/B-SFH18-160	P2771614	18	33	42	160	50	M12×1.0	2	1.60
	BT40AD/B-SFH20-90	P2771615	20	33	42	90	52	M16×1.0	2	1.40
BT40AD/B-SFH20-160	P2771616	20	33	42	160	52	M16×1.0	2	1.70	
BT40AD/B-SFH25-100	P2771617	25	44	53	100	58	M16×1.0	2	1.70	
BT40AD/B-SFH25-160	P2771618	25	44	53	160	58	M16×1.0	2	2.00	

▶ CAT(ANSI B5.50) taper and Inch type products are available.
▶ Without balancing screw.

SHRINK FIT HOLDER

**JIS B6339/
MAS 403-BT**

SCHRUMPFUTTER
MANDRIN DE FRETAGE
MADRINI PER CALLETAMENTO A CALDO
PORTAHERRAMIENTAS DE COMPRESION POR CALOR

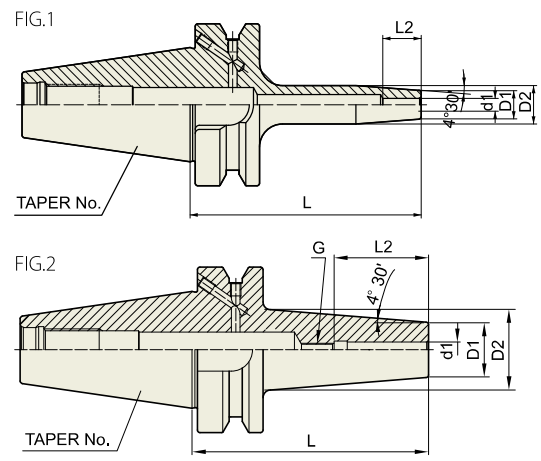

										Unit : mm
TAPER No.	MODEL No.	EDP No.	d1	D1	D2	L	L2	G	FIG.	WEIGHT (kg)
50	BT50AD/B-SFH3-100	P2771619	3	11	15	100	10	-	1	1.50
	BT50AD/B-SFH4-100	P2771620	4	11	15	100	12	-	1	1.50
	BT50AD/B-SFH5-100	P2771621	5	11	15	100	15	-	1	1.50
	BT50AD/B-SFH6-100	P2771622	6	21	27	100	36	M5×0.8	2	1.50
	BT50AD/B-SFH6-160	P2771623	6	21	27	160	36	M5×0.8	2	2.00
	BT50AD/B-SFH8-100	P2771624	8	21	27	100	36	M6×1.0	2	1.50
	BT50AD/B-SFH8-160	P2771625	8	21	27	160	36	M6×1.0	2	2.00
	BT50AD/B-SFH10-100	P2771626	10	24	32	100	42	M8×1.0	2	1.50
	BT50AD/B-SFH10-160	P2771627	10	24	32	160	42	M8×1.0	2	2.00
	BT50AD/B-SFH12-100	P2771628	12	24	32	100	47	M10×1.0	2	1.50
	BT50AD/B-SFH12-160	P2771629	12	24	32	160	47	M10×1.0	2	2.00
	BT50AD/B-SFH14-100	P2771630	14	27	34	100	47	M10×1.0	2	1.60
	BT50AD/B-SFH14-160	P2771631	14	27	34	160	47	M10×1.0	2	2.10
	BT50AD/B-SFH16-100	P2771632	16	27	34	100	50	M12×1.0	2	1.60
	BT50AD/B-SFH16-160	P2771633	16	27	34	160	50	M12×1.0	2	2.10
	BT50AD/B-SFH18-100	P2771634	18	33	42	100	50	M12×1.0	2	1.60
	BT50AD/B-SFH18-160	P2771635	18	33	42	160	50	M12×1.0	2	2.00
	BT50AD/B-SFH20-100	P2771636	20	33	42	100	52	M16×1.0	2	1.80
	BT50AD/B-SFH20-160	P2771637	20	33	42	160	52	M16×1.0	2	2.20
	BT50AD/B-SFH25-100	P2771638	25	44	53	100	58	M16×1.0	2	2.00
BT50AD/B-SFH25-160	P2771639	25	44	53	160	58	M16×1.0	2	2.40	

- ▶ CAT(ANSI B5.50) taper and Inch type products are available.
- ▶ Without balancing screw.



SHRINK FIT HOLDER

SFH

SHRINK FIT HOLDER (COOLANT CHANNEL)

JIS B6339/ MAS 403-BT

SCHRUMPFUTTER

MANDRIN DE FRETTAGE

MADRINI PER CALLETAMENTO A CALDO

PORTAHERRAMIENTAS DE COMPRESION POR CALOR

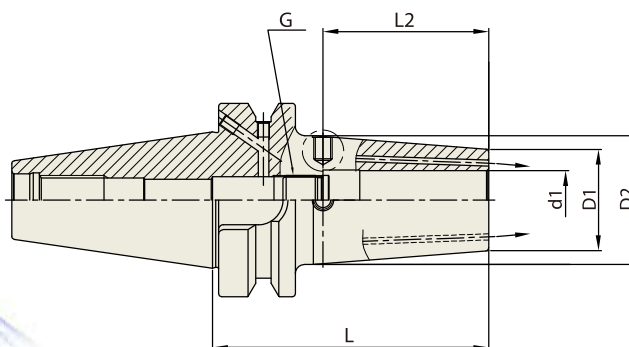

Unit : mm

TAPER No.	MODEL No.	EDP No.	d1	D1	D2	L	L2	G	WEIGHT (kg)
40	BT40AD/B-SFH6C-90	P2862085C	6	21	27	90	36	M5x0.8	1.10
	BT40AD/B-SFH6C-160	P2862086C	6	21	27	160	36	M5x0.8	1.15
	BT40AD/B-SFH8C-90	P2862087C	8	21	27	90	36	M6x1.0	1.11
	BT40AD/B-SFH8C-160	P2862088C	8	21	27	160	36	M6x1.0	1.15
	BT40AD/B-SFH10C-90	P2862089C	10	24	32	90	41	M8x1.0	1.10
	BT40AD/B-SFH10C-160	P2862090C	10	24	32	160	41	M8x1.0	1.15
	BT40AD/B-SFH12C-90	P2862091C	12	24	32	90	47	M10x1.0	1.10
	BT40AD/B-SFH12C-160	P2862092C	12	24	32	160	47	M10x1.0	1.15
	BT40AD/B-SFH14C-90	P2862093C	14	27	34	90	47	M10x1.0	1.20
	BT40AD/B-SFH14C-160	P2862094C	14	27	34	160	47	M10x1.0	1.50
	BT40AD/B-SFH16C-90	P2862095C	16	27	34	90	50	M12x1.0	1.20
	BT40AD/B-SFH16C-160	P2862096C	16	27	34	160	50	M12x1.0	1.50
	BT40AD/B-SFH18C-90	P2862097C	18	33	42	90	50	M12x1.0	1.30
	BT40AD/B-SFH18C-160	P2862098C	18	33	42	160	50	M12x1.0	1.60
	BT40AD/B-SFH20C-90	P2862099C	20	33	42	90	52	M16x1.0	1.40
	BT40AD/B-SFH20C-160	P2862100C	20	33	42	160	52	M16x1.0	1.70
BT40AD/B-SFH25C-100	P2862101C	25	44	53	100	58	M16x1.0	1.70	
BT40AD/B-SFH25C-160	P2862102C	25	44	53	160	58	M16x1.0	2.00	
50	BT50AD/B-SFH6C-100	P2862103C	6	21	27	100	36	M5x0.8	1.50
	BT50AD/B-SFH6C-160	P2862104C	6	21	27	160	36	M5x0.8	2.00
	BT50AD/B-SFH8C-100	P2862105C	8	21	27	100	36	M6x1.0	1.50
	BT50AD/B-SFH8C-160	P2862106C	8	21	27	160	36	M6x1.0	2.00
	BT50AD/B-SFH10C-100	P2862107C	10	24	32	100	42	M8x1.0	1.10
	BT50AD/B-SFH10C-160	P2862108C	10	24	32	160	42	M8x1.0	1.15
	BT50AD/B-SFH12C-100	P2862109C	12	24	32	100	47	M10x1.0	1.60
	BT50AD/B-SFH12C-160	P2862110C	12	24	32	160	47	M10x1.0	2.10
	BT50AD/B-SFH14C-100	P2862111C	14	27	34	100	47	M10x1.0	1.60
	BT50AD/B-SFH14C-160	P2862112C	14	27	34	160	47	M10x1.0	2.10
	BT50AD/B-SFH16C-100	P2862113C	16	27	34	100	50	M12x1.0	1.60
	BT50AD/B-SFH16C-160	P2862114C	16	27	34	160	50	M12x1.0	2.10
	BT50AD/B-SFH18C-100	P2862115C	18	33	42	100	50	M12x1.0	1.60
	BT50AD/B-SFH18C-160	P2862116C	18	33	42	160	50	M12x1.0	2.00
	BT50AD/B-SFH20C-100	P2862117C	20	33	42	100	52	M16x1.0	1.80
	BT50AD/B-SFH20C-160	P2862118C	20	33	42	160	52	M16x1.0	2.20
BT50AD/B-SFH25C-100	P2862119C	25	44	53	100	58	M16x1.0	2.00	
BT50AD/B-SFH25C-160	P2862120C	25	44	53	160	58	M16x1.0	2.40	

- ▶ CAT(ANSI B5.50) taper and Inch type products are available.
- ▶ Without balancing screw.
- ▶ Resealable Coolant Channel type is available upon request.

SHRINK FIT HOLDER (REINFORCED)

**JIS B6339/
MAS 403-BT**

SCHRUMPFUTTER (VERSTÄRKT)
MANDRIN DE FRETAGE (RENFORCÉ)
MADRINI PER CALLETAMENTO A CALDO (RINFORZATO)
PORTAHERRAMIENTAS DE COMPRESIÓN POR CALOR (REFORZADO)

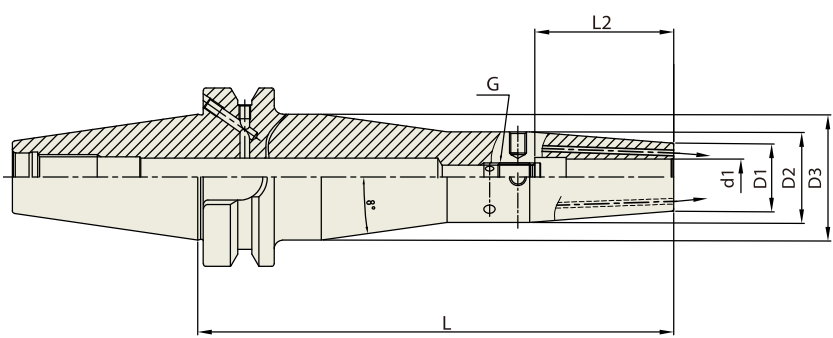

Unit : mm

TAPER No.	MODEL No.	EDP No.	d1	D1	D2	D3	L	L2	G	WEIGHT (kg)
40	BT40AD/B-SFH6C TW-160	P2801601TW	6	21	27	41.9	160	36	M5x0.8	1.64
	BT40AD/B-SFH8C TW-160	P2801602TW	8	21	27	41.9	160	36	M6x1.0	1.63
	BT40AD/B-SFH10C TW-160	P2801603TW	10	24	32	46.9	160	42	M8x1.0	1.84
	BT40AD/B-SFH12C TW-160	P2801604TW	12	24	32	46.9	160	47	M10x1.0	1.83
	BT40AD/B-SFH14C TW-160	P2801605TW	14	27	34	48.9	160	47	M10x1.0	1.80
	BT40AD/B-SFH16C TW-160	P2801606TW	16	27	34	48.9	160	50	M12x1.0	1.92
50	BT50AD/B-SFH6C TW-160	P2801607TW	6	21	27	38.8	160	36	M5x0.8	4.12
	BT50AD/B-SFH8C TW-160	P2801608TW	8	21	27	38.8	160	36	M6x1.0	4.57
	BT50AD/B-SFH10C TW-160	P2801609TW	10	24	32	43.8	160	42	M8x1.0	4.76
	BT50AD/B-SFH12C TW-160	P2801610TW	12	24	32	43.8	160	47	M10x1.0	4.74
	BT50AD/B-SFH14C TW-160	P2801611TW	14	27	34	45.8	160	47	M10x1.0	4.70
	BT50AD/B-SFH16C TW-160	P2801612TW	16	27	34	45.8	160	50	M12x1.0	4.69
	BT50AD/B-SFH20C TW-160	P2801613TW	20	33	42	53.8	160	52	M16x1.0	5.17

▶ CAT(ANSI B5.50) taper and Inch type products are available.
▶ Without balancing screw.

SHRINK FIT HOLDER

ISO 25

SCHRUMPFUTTER
 MANDRIN DE FRETTAGE
 MADRINI PER CALLETAMENTO A CALDO
 PORTAHERRAMIENTAS DE COMPRESION POR CALOR

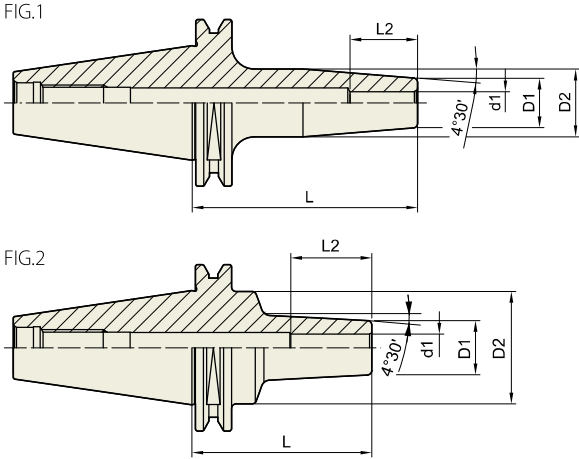

Unit : mm

TAPER No.	MODEL No.	EDP No.	d1	D1	D2	L	L2	FIG.	WEIGHT (kg)
25	ISO25-SFH3-50	P2771651	3	11	15	50	10	1	
	ISO25-SFH4-50	P2771652	4	11	15	50	12	1	
	ISO25-SFH5-50	P2771653	5	11	15	50	15	1	
	ISO25-SFH6-40	P2771654	6	12	17	40	18	2	
	ISO25-SFH8-50	P2771655	8	14	18	50	30	2	
	ISO25-SFH10-50	P2771656	10	16	20	50	37	2	

- Higher balancing grade is available upon request.
- To be supplied with assembling of pull stud bolt.

HYDRAULIC CHUCK

SHRINK FIT HOLDER

ER COLLET CHUCK

END MILL HOLDER & SIDE LOCK ARBOR

SHELL MILL ARBOR

POWER MILLING CHUCK

MORSE TAPER ARBOR

SK SLIM CHUCK

SYNCHRO TAPPING CHUCK

ONE STEP TAPPING CHUCK

TAPPING ER CHUCK

TAPPING CHUCK

FACE MILL ARBOR

COPY MILL ARBOR & INDEXABLE DRILL HOLDER

NC DRILL CHUCK & OTHER TOOL HOLDERS

BORING SYSTEM

ACCESSORY & OTHERS

SHRINK FIT HOLDER (EXTENSION)

STRAIGHT

SCHRUMPFUTTER (VERLÄGERUNG)
 MANDRIN DE FRETAGE (EXTENSION)
 MADRINI PER CALLETAMENTO A CALDO (PROLUNGHE)
 PORTAHERRAMIENTAS DE COMPRESION POR CALOR (EXTENSION)

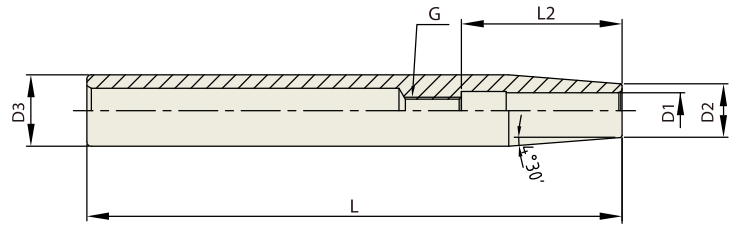

Unit : mm

TAPER No.	MODEL No.	EDP No.	D1	D2	D3	L	L1	G	WEIGHT (kg)
12	ST12-SFH3-120	P2767010	3	8	12	120	10	-	0.05
	ST12-SFH4-120	P2767015	4	8	12	120	12	-	0.05
	ST12-SFH5-120	P2771701	5	10	12	120	15	-	0.08
	ST12-SFH6-120	P2771709	6	10	12	120	36	M5×0.8	0.07
16	ST16-SFH3-120	P2767110	3	10	16	120	10	-	0.14
	ST16-SFH4-120	P2767115	4	10	16	120	12	-	0.14
	ST16-SFH5-120	P2771702	5	10	16	120	15	-	0.14
	ST16-SFH6-120	P2771710	6	10	16	120	36	M5×0.8	0.14
	ST16-SFH8-120	P2771711	8	12	16	120	36	M6×1.0	0.12
20	ST20-SFH3-120	P2771703	3	10	20	120	10	-	0.21
	ST20-SFH4-120	P2771704	4	10	20	120	12	-	0.21
	ST20-SFH5-120	P2771705	5	10	20	120	15	-	0.20
	ST20-SFH6-120	P2771712	6	10	20	120	36	M5×0.8	0.20
	ST20-SFH8-120	P2771713	8	12	20	120	36	M6×1.0	0.19
	ST20-SFH10-120	P2771714	10	14	20	120	43	M8×1.0	0.20
	ST20-SFH12-120	P2771715	12	16	20	120	48	M10×1.0	0.18

► Inch type products are available.



SHRINK FIT HOLDER

SFH

SHRINK FIT HOLDER (EXTENSION)

STRAIGHT

SCHRUMPFUTTER (VERLÄGERUNG)

MANDRIN DE FRETAGE (EXTENSION)

MADRINI PER CALLETAMENTO A CALDO (PROLUNGHE)

PORTAHERRAMIENTAS DE COMPRESION POR CALOR (EXTENSION)

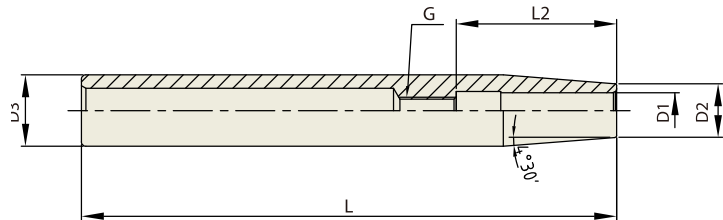

Unit : mm

TAPER No.	MODEL No.	EDP No.	D1	D2	D3	L	L1	G	WEIGHT (kg)
12	ST12-SFH3-160	P2767020	3	8	12	160	10	-	0.07
	ST12-SFH4-160	P2767025	4	8	12	160	12	-	0.07
	ST12-SFH5-160	P2771706	5	10	12	160	15	-	0.10
	ST12-SFH6-160	P2767030	6	10	12	160	36	M5×0.8	0.13
16	ST16-SFH3-160	P2767120	3	10	16	160	10	-	0.20
	ST16-SFH4-160	P2767125	4	10	16	160	12	-	0.20
	ST16-SFH5-160	P2771707	5	10	16	160	15	-	0.20
	ST16-SFH6-160	P2767130	6	10	16	160	36	M5×0.8	0.19
	ST16-SFH8-160	P2767135	8	12	16	160	36	M6×1.0	0.16
20	ST20-SFH3-160	P2767210	3	10	20	160	10	-	0.30
	ST20-SFH4-160	P2767215	4	10	20	160	12	-	0.30
	ST20-SFH5-160	P2771708	5	10	20	160	15	-	0.29
	ST20-SFH6-160	P2767220	6	10	20	160	36	M5×0.8	0.29
	ST20-SFH8-160	P2767225	8	12	20	160	36	M6×1.0	0.27
	ST20-SFH10-160	P2767230	10	14	20	160	43	M8×1.0	0.27
25	ST25-SFH12-160	P2767235	12	16	20	160	48	M10×1.0	0.23
	ST25-SFH3-160	P2771716	3	10	25	160	10	-	0.41
	ST25-SFH4-160	P2771717	4	10	25	160	12	-	0.39
	ST25-SFH5-160	P2771718	5	15	25	160	15	-	0.50
	ST25-SFH6-160	P2771719	6	20	25	160	36	M5×0.8	0.55
	ST25-SFH8-160	P2771720	8	20	25	160	36	M6×1.0	0.51
	ST25-SFH10-160	P2771721	10	20	25	160	43	M8×1.0	0.50
	ST25-SFH12-160	P2771722	12	20	25	160	48	M10×1.0	0.44
	ST25-SFH14-160	P2771723	14	20	25	160	48	M10×1.0	0.40
32	ST25-SFH16-160	P2771724	16	22	25	160	51	M12×1.0	0.39
	ST32-SFH6-160	P2771725	6	20	32	160	36	M5×0.8	0.92
	ST32-SFH8-160	P2771726	8	20	32	160	36	M6×1.0	0.88
	ST32-SFH10-160	P2771727	10	24	32	160	43	M8×1.0	0.83
	ST32-SFH12-160	P2771728	12	24	32	160	48	M10×1.0	0.78
	ST32-SFH14-160	P2771729	14	27	32	160	48	M10×1.0	0.78
	ST32-SFH16-160	P2771730	16	27	32	160	51	M12×1.0	0.76
	ST32-SFH18-160	P2771731	18	27	32	160	51	M12×1.0	0.63
ST32-SFH20-160	P2771732	20	27	32	160	53	M16×1.0	0.60	

► Inch type products are available.

SHRINK FIT HEATING MACHINE

TECHINCAL INFORMATION

FEATURE

- ▶ Electromagnetic induction heating system
- ▶ Automatic voltage adjustment : AC 100V~240V
- ▶ Small size and light weight
- ▶ Easy to operate

SPECIFICATION

CHARACTERISTICS	SPECIFICATION
MODEL No.	SF-3300
EDP No.	P2781003
Power	100V~240V AC, 50/60Hz, Max. 3.6KW
Dimension	380(W) x 350(D) x 720(H)mm
Weight	22Kg
Holder Support	SK, HSK, BT





Global Cutting Tool Leader **YG-1**

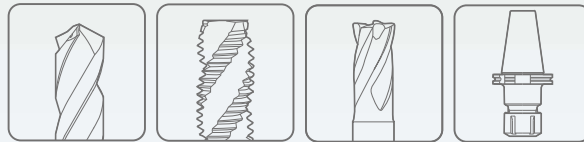



HEAD OFFICE

13-40, Songdogwahak-ro 16beon-gil, Yeonsu-gu, Incheon 21984, South Korea

Notice YG-1 Global head office is relocating from December 2020 to a new address as above;

Phone: +82-32-526-0909

Https://www.yg1.kr **E-mail:** yg1@yg1.kr

Note The information is provided for reference only. Tool specifications are subject to change without prior notice.
Although we endeavor to supply accurate and timely information, there can be no guarantee to cover every particular application.
YG-1 or publishers are not liable for any damage for use of the information.



Search 'YG-1' on social media outlets

YG1YE211020002-1